



WWW.TENRITEPUMP.COM

# PUMPS

*Pompe. Pompy. Bombas*

TENRITE  
腾力泵业 | POMPE

福安市腾力泵业有限公司  
FUAN TEN-RITE PUMP INDUSTRY CO.,LTD.

Add: Daliu Industry Zone, Luojiang, Fuan, Fujian, CHINA.

Tel: +86-593-6398953 Fax: +86-593-6995337

E-mail: info@tenritepump.com

www.tenritepump.com



TENRITE  
腾力泵业 | POMPE

# PUMPS

*Pompe. Pompy. Bombas*

福安市腾力泵业有限公司  
FUAN TEN-RITE PUMP INDUSTRY CO.,LTD.

WWW.TENRITEPUMP.COM

# About TEN-RITE Pompe

# PRODUCT CATALOGUE

## TEN-RITE — JUST YOU'RE LOOKING FOR

Originated from TPI – FUJIAN TEMCO POWER INDUSTRY CO., LTD.

TEN-RITE pompe is a professional manufacture and exporter of household water pumps, located in Fuan city, Fujian Province, which is well-known as the Chinese Electric Motor City.

With more than 15 year's product and market experience, the company has established firm reputation in High Quality standard, Honest Business Policy and Excellent Service. The company has got ISO9001:2000 certification, and all our products are along with CE, EMC, GS certificates., part of the items have got SASO, SONCAP licence. Based on monthly capacity of 30K pcs, we have shared main market in East Europe, Middle East and Middle South American countries.

Meanwhile our company was honoured as High Tech Enterprise and Fujian Top Brand.

**Sincerely Wellcomed to TEN-RITE Pompe.**



### CENTRIFUGAL PUMP SERIES

» CPM Series	04
» SCM Series	06
» PX Series	08
» DTM Series	10
» DK/DKMSeries	12
» INOXML Series	14
» SCM2 Series	20



### PERIPHERAL PUMP SERIES

» QB/PKM Series	24
» PM/KPM Series	26
» TPS Series	28
» GP Series	30



### AIR COOLED ENGINE PUMP SERIES

» WPG Series	32
» WPD Series	33



### SELF-PRIMING JET PUMP SERIES

» JET-C Series	36
» JETS Series	38
» JET-S/CAM Series	40
» JET-L/M80 Series	42
» JET-P/102M Series	44
» JSW/JSP Series	46
» JETDP/JDW Series	48
» TDL Series	50



### COMMERCIAL PUMP SERIES

» CP(C) Series	54
» AUTO BOOSTER SYSTEM	58
» TOP OIL PUMP	59



### 60 ACCESSORIES

# CENTRIFUGAL PUMP



# CENTRIFUGAL PUMP

## FUNCTIONING PRINCIPLE

These series of electric impeller close coupled centrifugal pumps are fitted with the overhang impeller directly splined key way on to the motor shaft. The liquid pumped is conveyed into the spiral shaped volute of the pump body transforming the kinetic energy into dynamic pressure energy. Pressure and flow is achieved with minimum loss by means of the hydrodynamic closed impeller design.

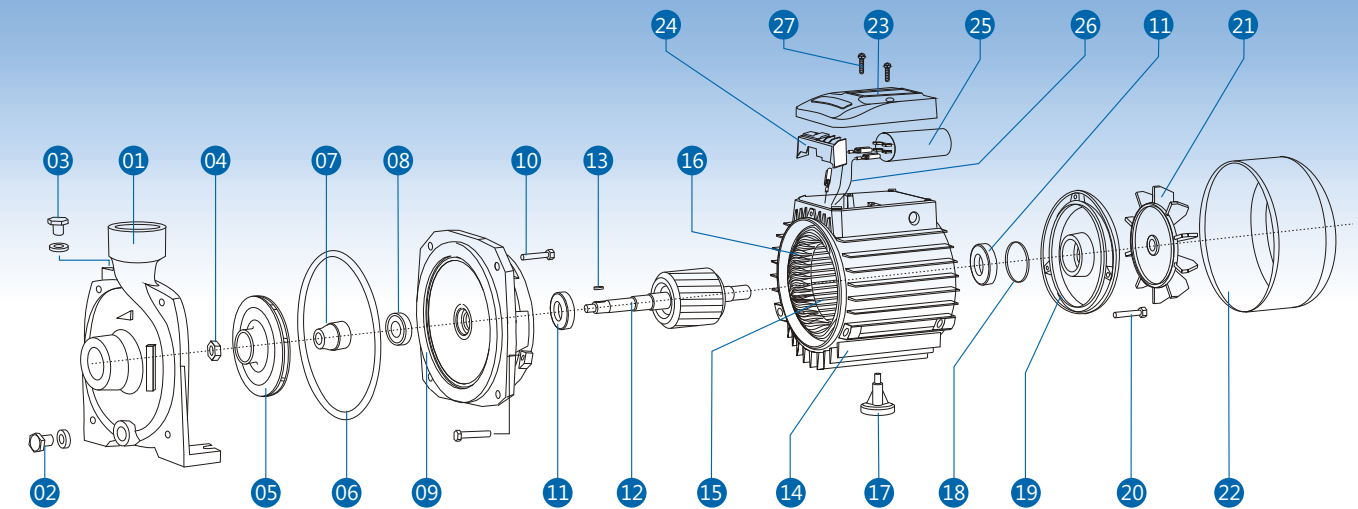

NO.	Name	NO.	Name	NO.	Name	NO.	Name
01	Pump body	08	Mechanical seal	15	Stator	22	Fan cover
02	Coper Screw	09	Motor front cover	16	Stator Coil	23	Terminal cover
03	Flit plug Screw	10	Screw	17	Motor Foot	24	Terminal block
04	Locking nut	11	Ball bearing	18	Spring Washer	25	Capacitor
05	Impeller	12	Motor Rotor	19	Motor End Cover	26	Connection wire
06	O Ring	13	Shaft Key	20	Tle bolt	27	Screw
07	Mechanical seal	14	Motor Body	21	Fan		

# CPM

## CENTRIFUGAL PUMP

### OPERATING LIMITATIONS

- » Max ambient temperature up to 40°C
- » Max fluid temperature up to 80°C
- » Max pressure up to 10 bar
- » Installed in a covered area, protected against the weather.



CPM-158T

CPM-158

### APPLICATIONS AND INSTALLATION

The CPM series pumps are high-efficient, power-saving and compact in structure, consist of a minniture motor and a single impelly convenient to operate and maintain. The hydraulic characteristic is with high head and small capacity. They are suitable for both domestic and industrial applications to convey clean water and non-aggressive chemical liquid, also can be applied to supply the water for garden, hotel, villas and agricultural irrigation, etc.

### CONSTRUCTION FEATURES

- » Pump body: Cast iron T-Electrophoresis
- » Motor housing: Aluminum
- » Shaft: 45#Steel / Stainless welding steel
- » Impeller: Brass / S.Steel
- » Motor: Closed, Externally ventilated
- » Insulation class: F
- » Protection class: IP44 / IP54
- » Duty: Continuously rated
- » Mechanical seal: Ceramic steatite / Metalized carbon

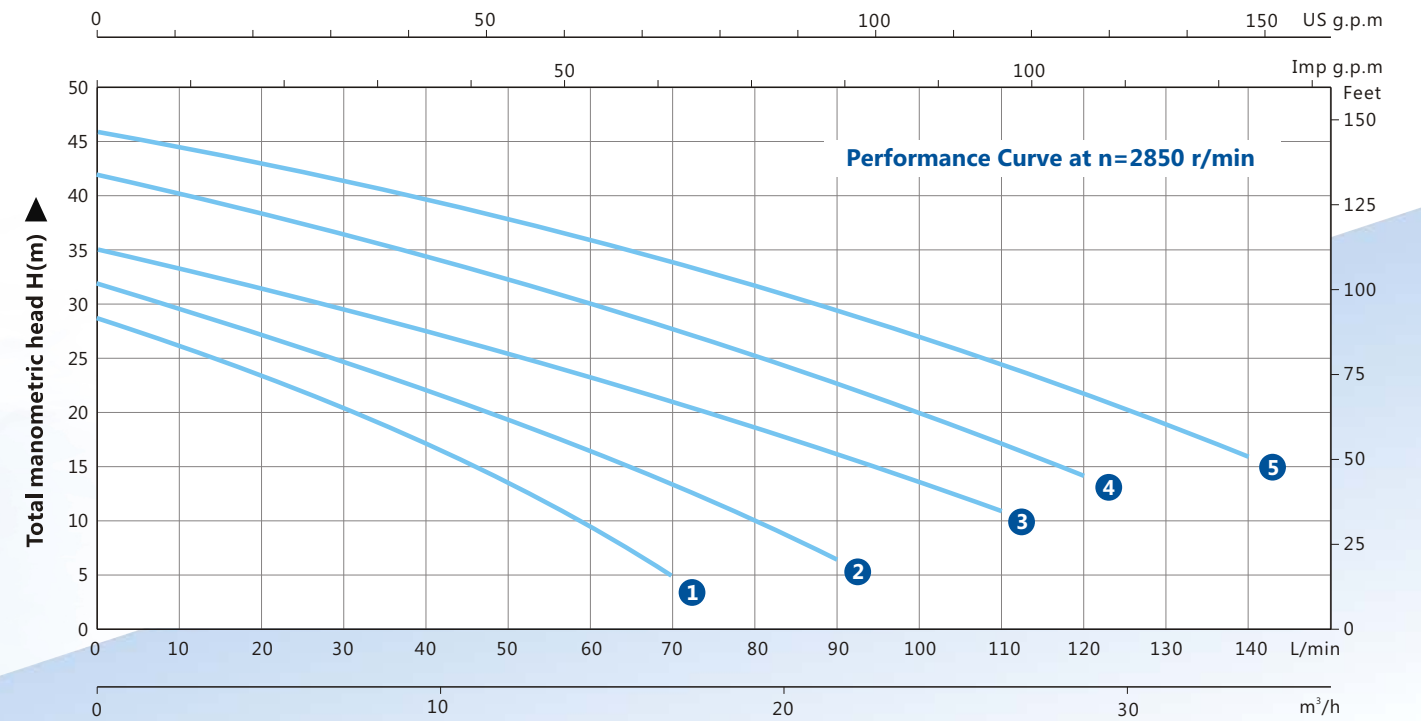

① CPM-130 ② CPM-146 ③ CPM-158 ④ CPM-180 ⑤ CPM-200

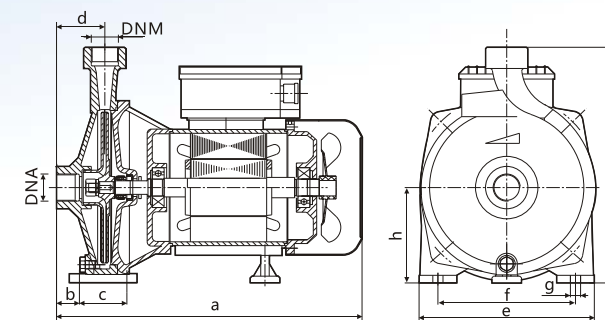

### TECHNICAL DATA (220~240V/50HZ, 2850rpm)

Model	Single-phase Motor			n=2850r/min		
	Input max kW	Output Power kW	Current A	Q.max L/min	H.max m	Suct.max m
CPM-130	0.60	0.40	2.9	70	28	
CPM-146	0.75	0.55	3.8	90	32	
CPM-158	1.10	0.75	5.2	110	35	9
CPM-180	1.50	1.10	7.0	120	42	
CPM-200	2.00	1.50	9.6	140	46	

Other voltages and frequencies available on request.

### OVERALL & INSTALLATION DIMENSIONS

Model	DIMENSIONS (mm)															PACKAGE DIMENSIONS & G.W.					
	DNA		DNM		a	b	c	d	e	f	g	h	i	j	k	l	m	A	B	H	kg
	Inch	mm	Inch	mm																	
CPM-130	1"	25	1"	25	295	--	--	42	170	135	10	82	211	--	--	--	--	310	180	235	8.9
CPM-146	1"	25	1"	25	305	--	--	44	190	160	10	100	242	--	--	--	--	340	210	261	12.2
CPM-158	1"	25	1"	25	305	--	--	44	190	160	10	100	242	--	--	--	--	340	210	261	13.8
CPM-180	1"	25	1"	25	360	--	--	53	207	160	10	112	262	--	--	--	--	425	250	320	21
CPM-200	1"	25	2"	25	388	32	--	60	207	160	10	112	259	--	--	--	--	425	250	320	23

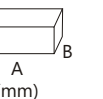

# SCM

## CENTRIFUGAL PUMP

### OPERATING LIMITATIONS

- » Max ambient temperature up to 40°C
- » Max fluid temperature up to 80°C
- » Max pressure up to 10 bar
- » Installed in a covered area, protected against the weather.



SCM-50T

SCM-50



CM-20

### APPLICATIONS AND INSTALLATION

The SCM series pumps are larger flow with lower discharge head, power-saving and compact in structure, consist of a mininature motor and a single impelly convenient to operate and maintain. The hydraulic characteristic is with lower head and large capacity. They are suitable for both domestic and industrial applications to convey clean water and non-aggressive chemical liquid, also can be applied to supply the water for garden, hotel, villas and agricultural irrigation, etc.

### CONSTRUCTION FEATURES

- » Pump body: Cast iron T-Eletrophoresis
- » Motor housing: Aluminum
- » Shaft: 45#Steel / Stainless welding steel
- » Impeller: Brass / Stainless steel
- » Motor: Closed, Externally ventilated
- » Insulation class: F
- » Protection class: IP44 / IP54
- » Duty: Continuously rated
- » Mechanical seal: Ceramic steatite / Metalized carbon

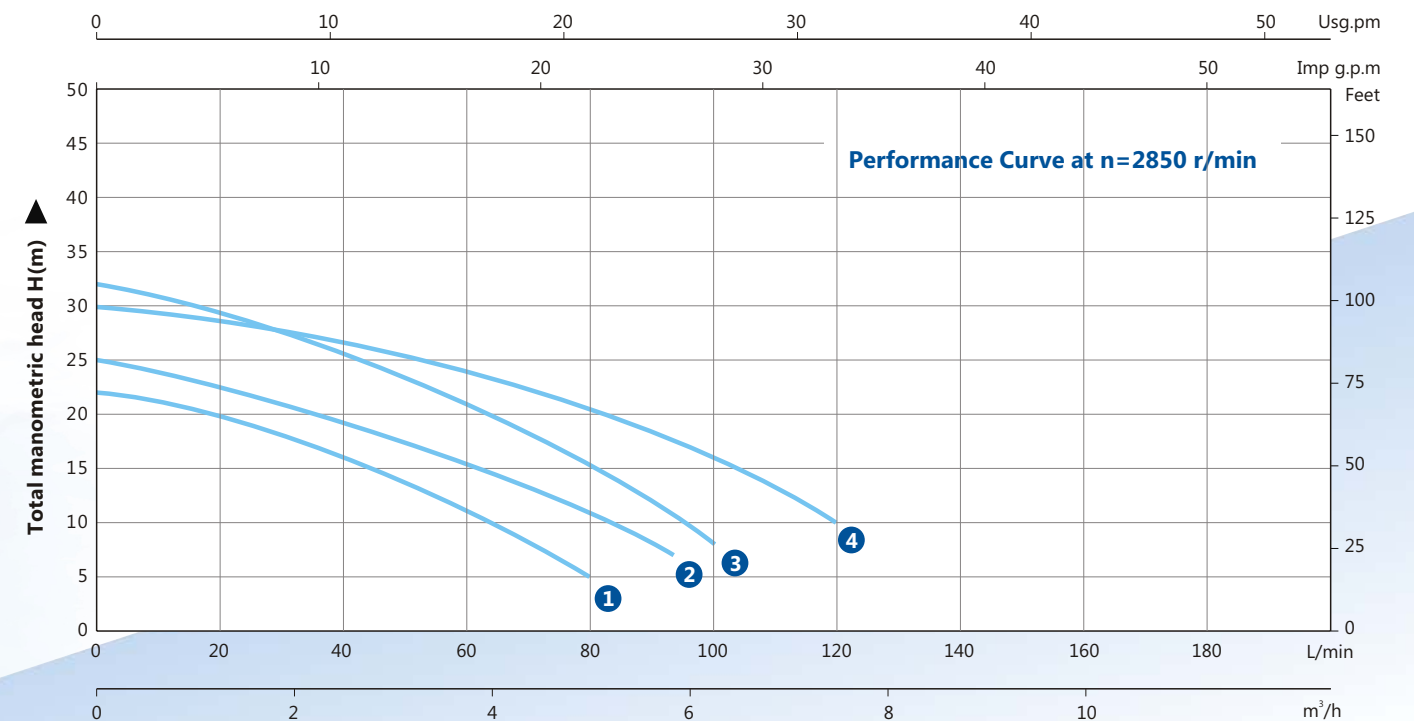

① SCM-22 ② SCM-42 ③ SCM-50 ④ CM-20

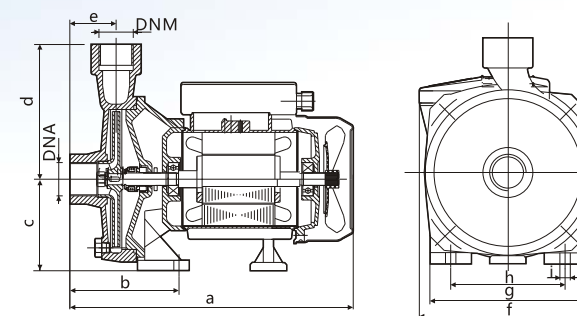

### TECHNICAL DATA (220~240V/50HZ, 2850rpm)

Model	Single-phase Motor			n=2850r/min		
	Input max kW	Output Power kW	Current A	Q.max L/min	H.max m	Suct.max m
SCM-22	0.60	0.40	2.9	80	22	9
SCM-42	0.80	0.55	3.8	95	25	
SCM-50/T	1.10	0.75	5.2	110	32	
CM-20	1.10	0.75	5.2	120	30	

Other voltages and frequencies available on request.

### OVERALL & INSTALLATION DIMENSIONS

Model	DIMENSIONS (mm)															PACKAGE DIMENSIONS & G.W.					
	DNA		DNM		a	b	c	d	e	f	g	h	i	j	k	l	m	A	B	H	kg
	Inch	mm	Inch	mm																	
SCM-22	1"	25	1"	25	275	100	83	114	43	160	150	108	10	--	--	--	--	310	170	235	8.8
SCM-42	1"	25	1"	25	303	108	98	144	45	165	181	140	10	--	--	--	--	330	200	260	12.0
SCM-50	1"	25	1"	25	303	108	98	144	45	185	181	140	10	--	--	--	--	330	200	260	13.6
CM-20	1"	25	1"	25	303	108	98	144	45	185	181	140	10	--	--	--	--	330	205	255	14.0

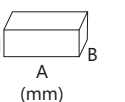

# PX

## CENTRIFUGAL PUMP

### OPERATING LIMITATIONS

- » Max ambient temperature up to 40°C
- » Max fluid temperature up to 80°C
- » Max pressure up to 10 bar
- » Installed in a covered area, protected against the weather.



### APPLICATIONS AND INSTALLATION

The PX series pumps are larger flow with lower discharge head, power-saving and compact in structure, consist of a mininature motor and a single impelly convenient to operate and maintain. The hydraulic characteristic is with low head and large capacity. They are suitable for both domestic and industrial applications to convey clean water and non-aggressive chemical liquid, also can be applied to supply the water for garden, hotel, villas and agricultural irrigation, etc.

### CONSTRUCTION FEATURES

- » Pump body: Cast iron
- » Motor housing: Cast iron
- » Shaft: 45#Steel / Stainless welding steel
- » Impeller: Brass / Cast iron / Alumium
- » Motor: Closed, Externally ventilated
- » Insulation class: F
- » Protection class: IP44 / IP54
- » Duty: Continuously rated
- » Mechanical seal: Ceramic steatite / Metalized carbon

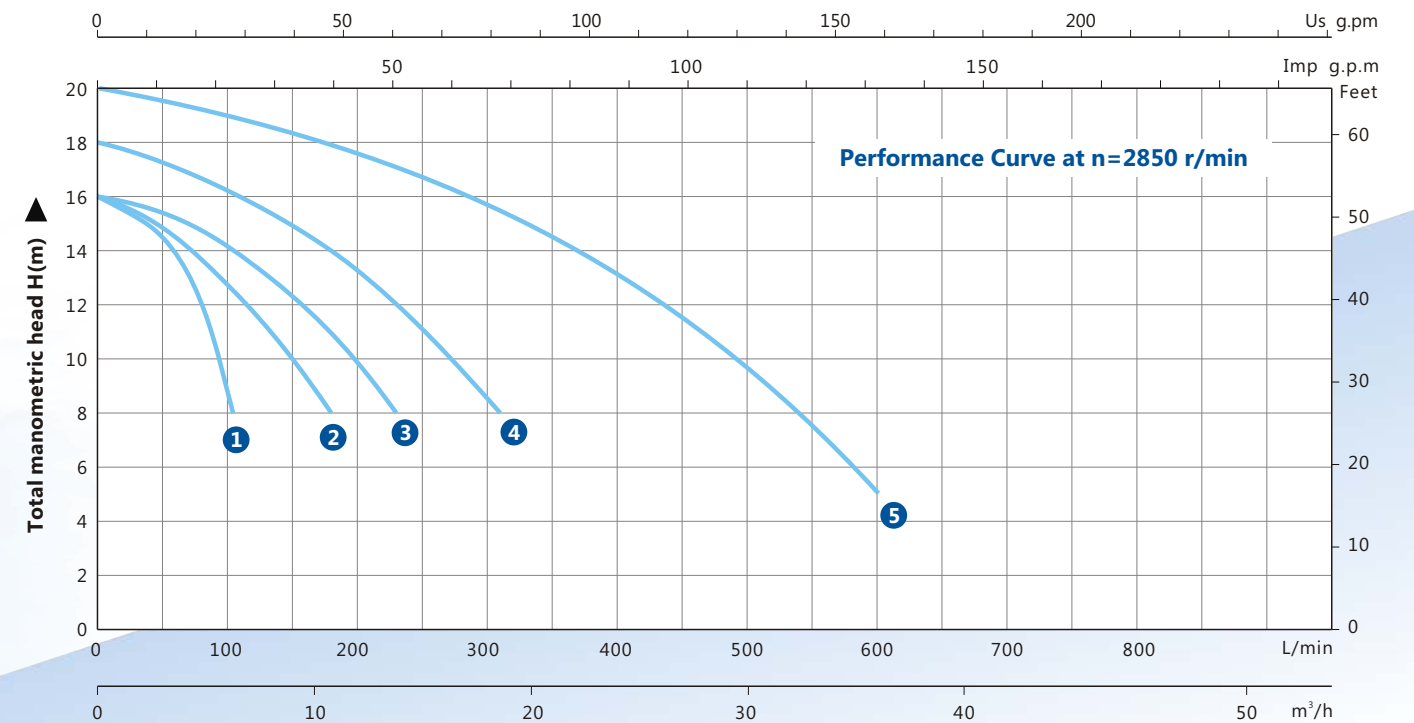

① PX-201 ② PX-203 ③ PX-204 ④ PX-205 ⑤ PX-207

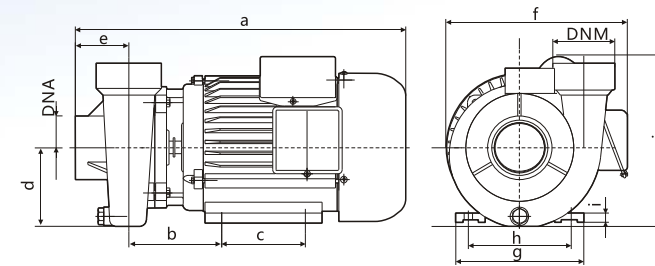

### TECHNICAL DATA (220~240V/50HZ, 2850rpm)

Model	Single-phase Motor			n=2850r/min		
	Input max kW	Output Power kW	Current A	Q.max L/min	H.max m	Suct.max m
PX-201	0.80	0.55	3.8	105	16	
PX-203	1.10	0.75	5.2	180	16	
PX-204	1.50	1.10	7.0	230	16	9
PX-205	2.10	1.50	9.6	310	18	
PX-207	2.90	2.20	17.1	600	20	

Other voltages and frequencies available on request.

### OVERALL & INSTALLATION DIMENSIONS

Model	DIMENSIONS (mm)														PACKAGE DIMENSIONS & G.W.						
	DNA		DNM		a	b	c	d	e	f	g	h	i	j	k	l	m	A	B	H	kg
	Inch	mm	Inch	mm																	
PX-201	1"	25	1"	25	300	130	75	80	30	190	138	110	10	180	--	--	--	345	218	221	15.0
PX-203	1"	25	1"	25	330	155	90	80	45	190	138	110	10	199	--	--	--	360	220	230	16.5
PX-204	1.5"	40	1.5"	40	330	155	90	80	45	190	138	110	10	199	--	--	--	360	220	230	18.0
PX-205	2"	50	2"	50	390	182	100	90	67	226	168	140	10	206	--	--	--	435	277	263	22.0
PX-207	3"	75	3"	75	405	165	245	122	98	238	185	145	10	280	--	--	--	490	295	320	35.0



# DTM

## CENTRIFUGAL PUMP

### OPERATING LIMITATIONS

- » Max ambient temperature up to 40°C
- » Max fluid temperature up to 80°C
- » Max pressure up to 10 bar
- » Installed in a covered area, protected against the weather.



DTM2

DTM

### APPLICATIONS AND INSTALLATION

The DTM series pumps are larger flow with lower discharge head, power-saving and compact in structure, consist of a minniture motor and a single impelly convenient to operate and maintain. The hydraulic characteristic is with lower head and large capacity. They are suitable for both domestic and industrial applications to convey clean water and non-aggressive chemical liquid, also can be applied to supply the water for garden, hotel, villas and agricultural irrigation, etc.

### CONSTRUCTION FEATURES

- » Pump body: Cast iron
- » Motor housing: Aluminum
- » Shaft: 45#Steel / Stainless welding steel
- » Impeller: Brass
- » Motor: Closed, Externally ventilated
- » Insulation class: F
- » Protection class: IP44 / IP54
- » Duty: Continuously rated
- » Mechanical seal: Ceramic steatite / Metalized carbon

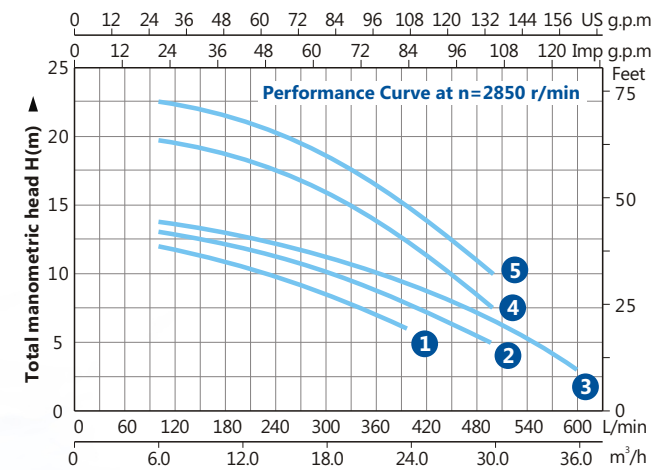

① DTM/5C ② DTM/5B  
③ DTM/5A ④ DTM/5BM ⑤ DTM/5AM

### TECHNICAL DATA (220~240V/50HZ, 2850rpm)

Model	Power		Inlet/Outlet	Max. Flow (L/min)	Max. Head (m)	Max. Suct (m)
	kW	HP				
DTM/5C	0.6	0.8	2"X2"	500	12.5	8
DTM/5B	0.75	1.0	2"X2"	650	13.7	8
DTM/5A	1.1	1.5	2"X2"	650	14.5	8
DTM/5BM	1.1	1.5	2"X2"	600	20.2	8
DTM/5AM	1.5	2.0	2"X2"	600	22.5	8

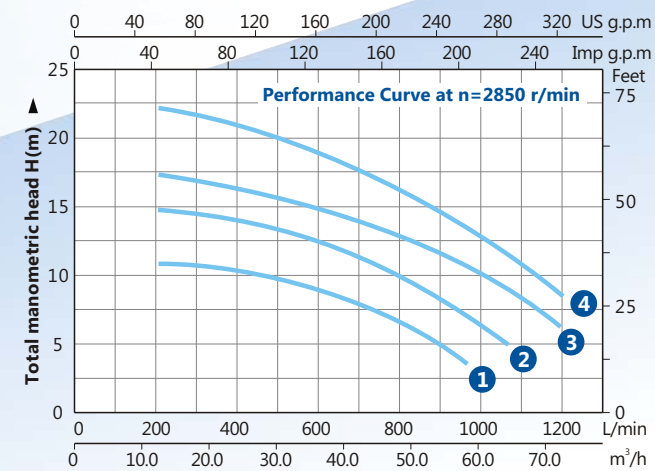

① DTM/6C / DTM/6CR ② DTM/6B / DTM/6BR  
③ DTM/6A / DTM/6AR ④ DTM/7B / DTM/7BR

### TECHNICAL DATA (220~240V/50HZ, 2850rpm)

Model	Power		Inlet/Outlet	Max. Flow (L/min)	Max. Head (m)	Max. Suct (m)
	kW	HP				
DTM/6C	1.1	1.5	3"X3"	1100	11.9	8
DTM/6CR	1.1	1.5	4"X4"	1100	11.9	8
DTM/6B	1.5	2.0	3"X3"	1200	14.7	8
DTM/6BR	1.5	2.0	4"X4"	1200	14.7	8
DTM/6A	2.2	3.0	3"X3"	1300	18.5	8
DTM/6AR	2.2	3.0	4"X4"	1300	18.5	8
DTM/7B	3.0	4.0	3"X3"	1300	21.8	8
DTM/7BR	3.0	4.0	4"X4"	1300	21.8	8

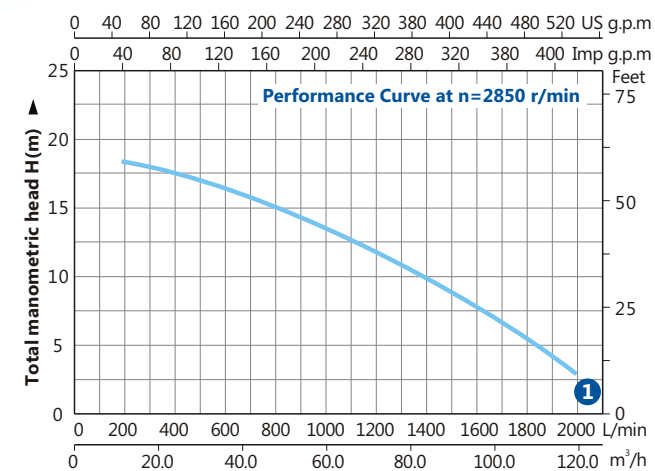

① DTM/7AR

### TECHNICAL DATA (220~240V/50HZ, 2850rpm)

Model	Power		Inlet/Outlet	Max. Flow (L/min)	Max. Head (m)	Max. Suct (m)
	kW	HP				
DTM/7AR	4	5.5	4"X4"	2200	18.8	8

# DK/DKM

## CENTRIFUGAL PUMP

### OPERATING LIMITATIONS

- » Max ambient temperature up to 40°C
- » Max fluid temperature up to 80°C
- » Max pressure up to 10 bar
- » Installed in a covered area, protected against the weather.



### APPLICATIONS AND INSTALLATION

The DK/DKM series pumps are larger flow with lower discharge head, power-saving and compact in structure, consist of a minniture motor and a single impelly convenient to operate and maintain. The hydraulic characteristic is with low head and large capacity. They are suitable for both domestic and industrial applications to convey clean water and non-aggressive chemical liquid, also can be applied to supply the water for garden, hotel, villas and agricultural irrigation, etc.

### CONSTRUCTION FEATURES

- » Pump body: Cast iron
- » Motor housing: Cast Iron
- » Shaft: 45#Steel / Stainless welding steel
- » Impeller: Brass / Cast iron / Alum
- » Motor: Closed, Externally ventilated
- » Insulation class: F
- » Protection class: IP44 / IP54
- » Duty: Continuously rated
- » Mechanical seal: Ceramic steatite / Metalized carbon

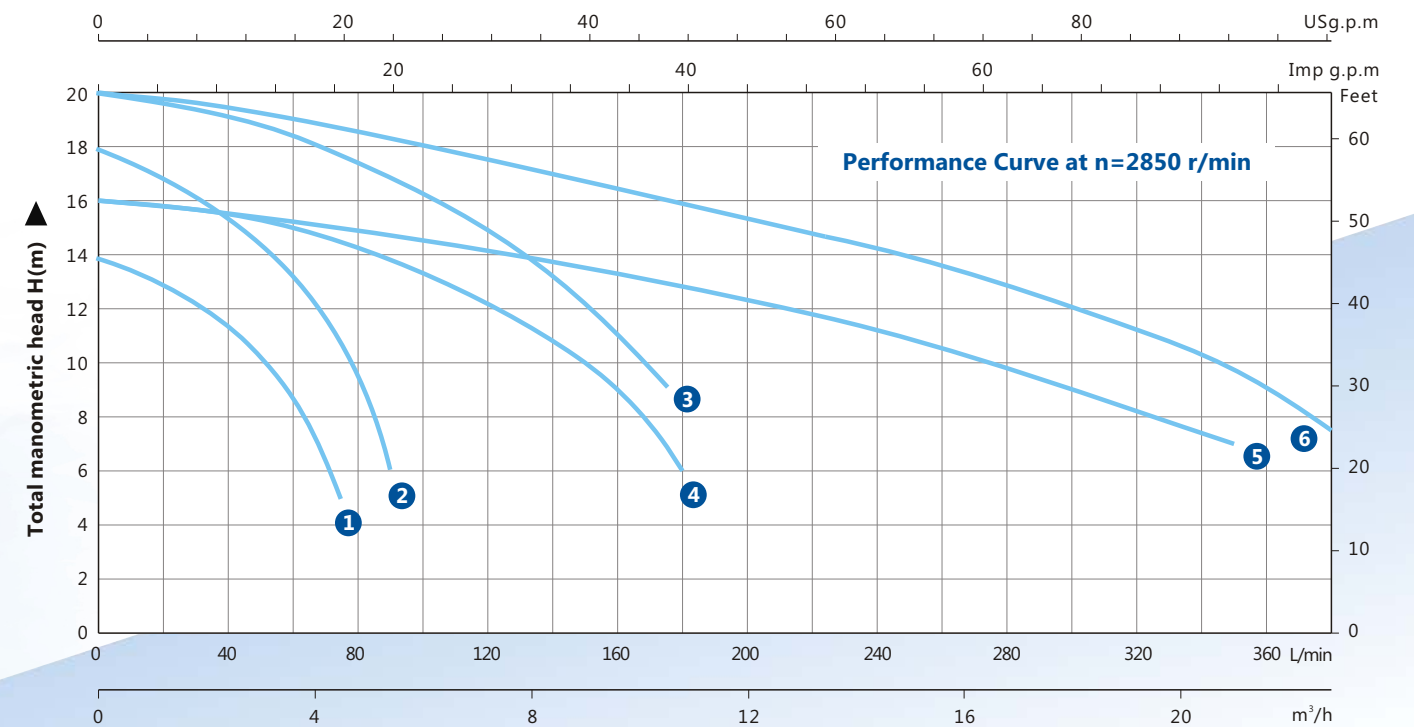

① 1DK-14 ② 1DK-20 ③ 1.5DK-20 ④ 1.5DKm-16 ⑤ 2DKm-16 ⑥ 2DKm-20

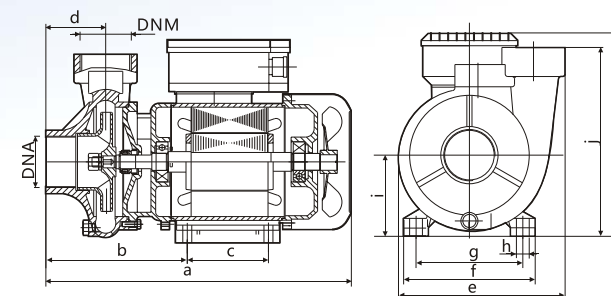

### TECHNICAL DATA (220~240V/50HZ, 2850rpm)

Model	Single-phase Motor			n=2850r/min		
	Input max kW	Output Power kW	Current A	Q.max L/min	H.max m	Suct.max m
1DK-14	0.55	0.37	2.5	75	14	9
1DK-20	0.80	0.55	3.8	90	18	
1.5DK-20	1.10	0.75	5.2	180	20	
1.5DKm-16	1.10	0.75	5.2	180	16	
2DKm-16	1.50	1.10	7.0	350	16	
2DKm-20	2.00	1.50	9.6	380	20	

Other voltages and frequencies available on request.

### OVERALL & INSTALLATION DIMENSIONS

Model	DIMENSIONS (mm)															PACKAGE DIMENSIONS & G.W.					
	DNA		DNM		a	b	c	d	e	f	g	h	i	j	k	l	m	A	B	H	kg
	Inch	mm	Inch	mm																	
1DK-14	1"	25	1"	25	44	77	80	260	148	118	100	10	63	173	--	--	--	300	175	210	7.4
1DK-20	1"	25	1"	25	44	78	90	298	168	136	112	10	71	191	--	--	--	328	173	214	11.2
1.5DK-20	1.5"	40	1.5"	40	43	78	90	298	168	136	112	10	71	191	--	--	--	325	175	215	13.0
1.5DKm-16	1.5"	40	1.5"	40	330	155	90	45	190	138	110	10	80	--	199	--	--	360	220	230	16.5
2DKm-16	2"	50	2"	50	360	162	92	61	185	162	130	10	90	--	207	--	--	380	235	250	23.0
2DKm-20	2"	50	2"	50	360	162	92	61	185	162	130	10	90	--	207	--	--	380	235	250	26.0

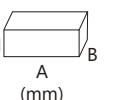

# INOXML-HA

## MULTISTAGE CENTRIFUGAL PUMP



Self-priming multi-stage pumps ideal for supplying water for domestic and gardening applications.

Low noise and high pressure performance.

Available with 2, 3, 4 and 5 impellers.

- » Anti-corrosive and rust-proof materials T-Electrophoresis
- » Motor with thermic overload protection
- » Double sealing system between motor and hydraulic part
- » High resistance to frost and icing
- » Supplied with power cable with plug, switch and self-sealing fitting

Traditional booster sets for supplying water for domestic applications.

- » Designed to automatically start and stop the pump when taps are opened or closed
- » Tank membrane made of butile
- » Compact design with drainage switch, manometer and drainage tap positioned on the tank flange

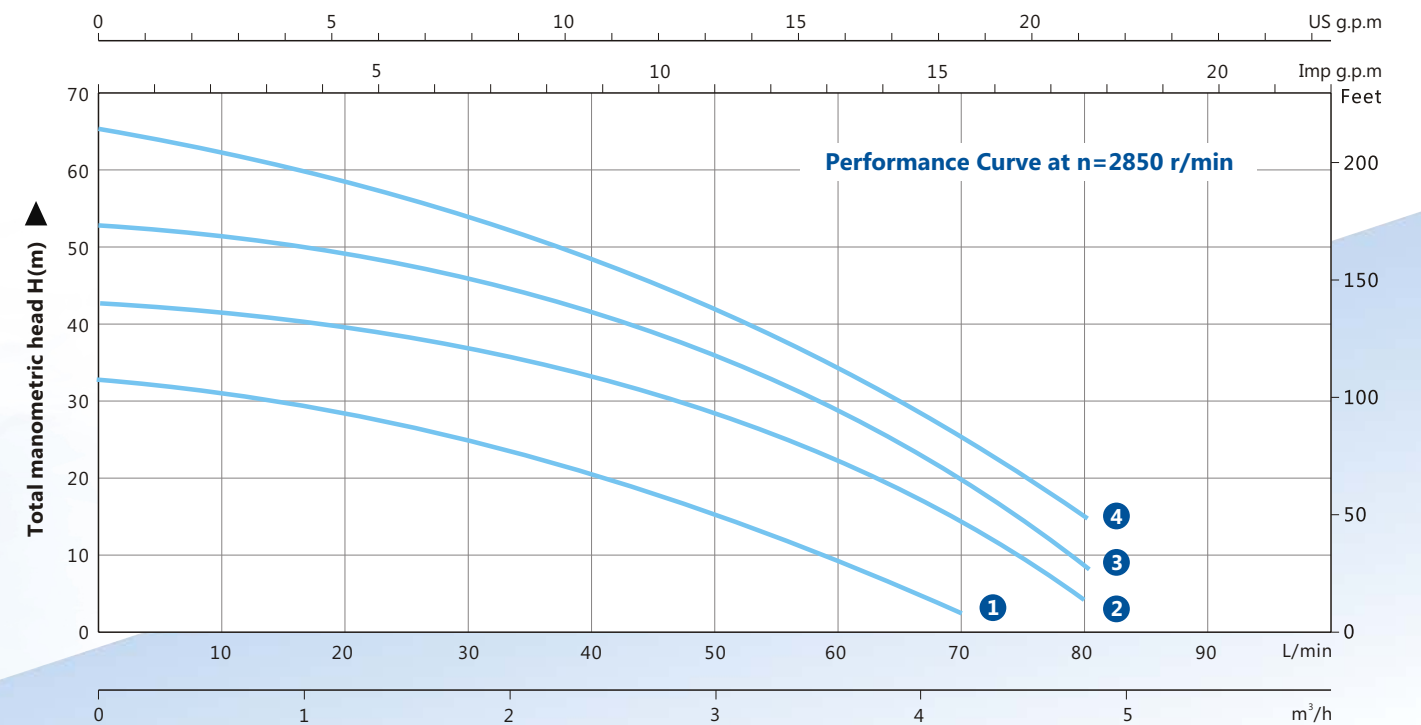

① INOXML-2HA ② INOXML-3HA ③ INOXML-4HA ④ INOXML-5HA

### TECHNICAL DATA (220~240V/50HZ, 2850rpm)

Model	Single-phase Motor			n=2850r/min		
	Input max kW	Output Power kW	Current A	Q.max L/min	H.max m	Suct.max m
INOXML-2HA	1.0	0.37	4.6	70	33	
INOXML-3HA	1.2	0.75	5.5	80	43	9
INOXML-4HA	1.3	0.90	6.0	80	52	
INOXML-5HA	1.5	1.10	7.0	80	65	

Other voltages and frequencies available on request.

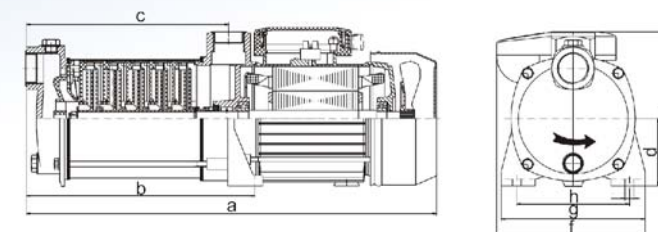

### OVERALL & INSTALLATION DIMENSIONS

Model	DIMENSIONS (mm)												PACKAGE DIMENSIONS & G.W.				
	DNA		DNM		a	b	c	d	e	f	g	h	i	A	B	H	kg
	Inch	mm	Inch	mm													
INOXML-2HA	1"	25	1"	25	385	187	165	71	164	158	152	119	9	42.5	21	22.5	13
INOXML-3HA	1"	25	1"	25	410	212	189.5	71	164	158	152	119	9	45	21	22.5	14
INOXML-4HA	1"	25	1"	25	434	236	214	71	164	158	152	119	9	47	21	22.5	15
INOXML-5HA	1"	25	1"	25	458	260	238	71	164	158	152	119	9	47.5	21	22.5	16

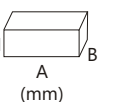

# INOXML-HB

## MULTISTAGE CENTRIFUGAL PUMP



Self-priming multi-stage pumps ideal for supplying water for domestic and gardening applications.  
Low noise and high pressure performance.  
Available with 3, 4 and 5 impellers.

- » Anti-corrosive and rust-proof materials T-Electrophoresis
- » Motor with thermic overload protection
- » Double sealing system between motor and hydraulic part
- » High resistance to frost and icing
- » Supplied with power cable with plug, switch and self-sealing fitting

Traditional booster sets for supplying water for domestic applications.

- » Designed to automatically start and stop the pump when taps are opened or closed
- » Tank membrane made of butile
- » Compact design with drainage switch, manometer and drainage tap positioned on the tank flange

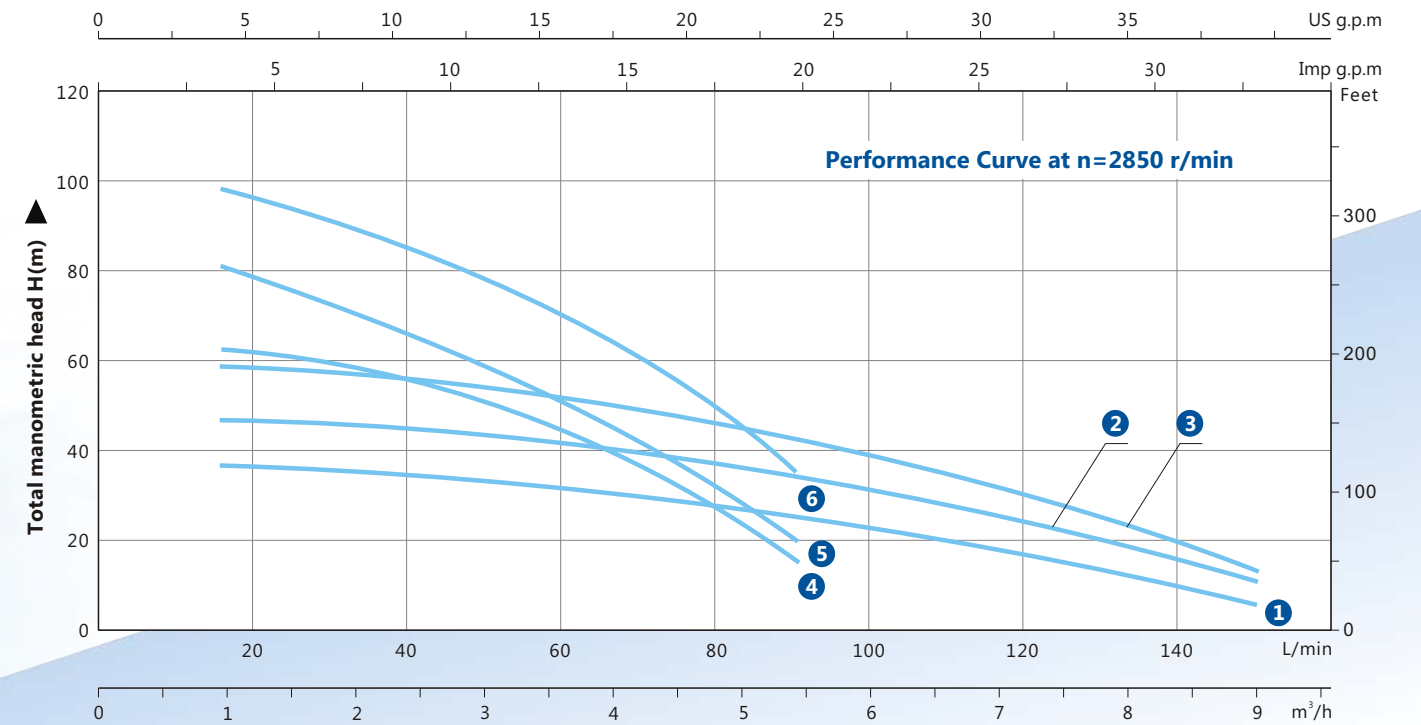

① INOXML-3HB ② INOXML-4HB ③ INOXML-5HB ④ INOXML-6HB ⑤ INOXML-8HB ⑥ INOXML-10HB

### TECHNICAL DATA (220~240V/50HZ, 2850rpm)

Model	Power		Q(m³/h)	0	0.9	1.8	2.7	3.6	4.5	5.4	6.3	7.2	8.1	9.0
	kW	HP		Q(l/min)	0	15	30	45	60	75	90	105	120	135
INOXML-3HB	1.1	1.5	H	36	35	34	32	30	27	23	19	15	10	5
INOXML-4HB	1.5	2		48	47	46	44	41	38	34	29	23	17	8
INOXML-5HB	1.8	2.5		60	58.5	57	55	51	46	41	35	28	20	10
INOXML-6HB	1.1	1.5		66	62	58	52	44	33	14				
INOXML-8HB	1.5	2		88	81	73	64	51	36	18				
INOXML-10HB	2.2	3		110	100	91	82	70	54	34				

### OVERALL & INSTALLATION DIMENSIONS

Model	Inlet/Outlet (Inch)	PACKAGE DIMENSIONS & G.W.			
		A	B	H	Kg
INOXML-3HB	1¼"X1¼"	440	210	240	15
INOXML-4HB	1¼"X1¼"	465	210	240	16
INOXML-5HB	1¼"X1¼"	490	210	240	17
INOXML-6HB	1"X1"	515	210	240	16.5
INOXML-8HB	1"X1"	565	210	240	18.5
INOXML-10HB	1"X1"	625	210	240	20

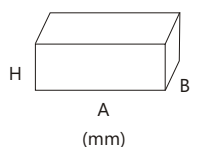

# INOXML-VA

## MULTISTAGE CENTRIFUGAL PUMP



Self-priming multi-stage pumps ideal for supplying water for domestic and gardening applications.  
Low noise and high pressure performance.  
Available with 2-10 impellers.

- » Anti-corrosive and rust-proof materials T-Electrophoresis
- » Motor with thermic overload protection
- » Double sealing system between motor and hydraulic part
- » High resistance to frost and icing
- » Supplied with power cable with plug, switch and self-sealing fitting

Traditional booster sets for supplying water for domestic applications.

- » Designed to automatically start and stop the pump when taps are opened or closed
- » Tank membrane made of butile
- » Compact design with drainage switch, manometer and drainage tap positioned on the tank flange

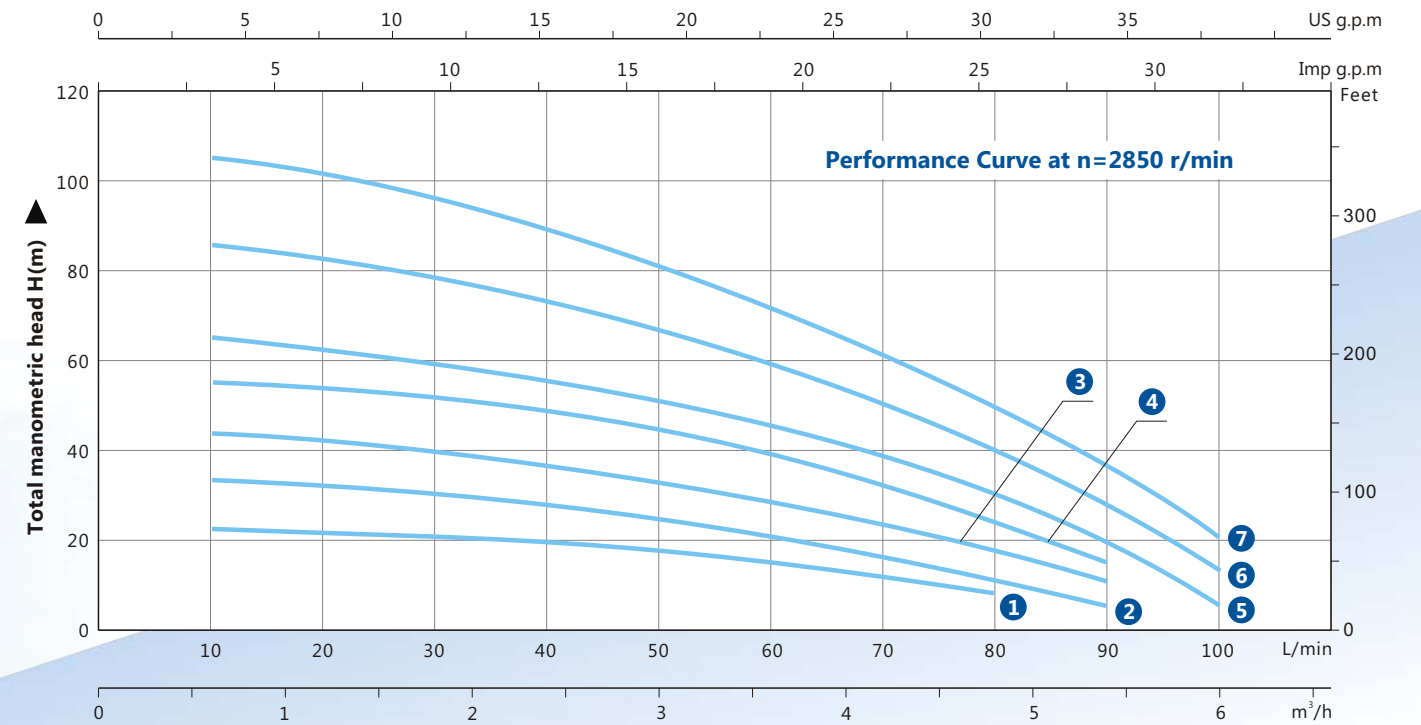

① INOXML-2VA ② INOXML-3VA ③ INOXML-4VA  
④ INOXML-5VA ⑤ INOXML-6VA ⑥ INOXML-8VA ⑦ INOXML-10VA

### TECHNICAL DATA (220~240V/50HZ, 2850rpm)

Model	Power		Q(m³/h)	0	0.6	1.2	1.8	2.4	3.0	3.6	4.2	4.8	5.4	6.0
	kW	HP		Q(l/min)	0	10	20	30	40	50	60	70	80	90
INOXML-2VA	0.37	0.5		22	21	20	19	18	16	14	11	8		
INOXML-3VA	0.55	0.75		33	32	30	28	26	23	20	16	11	5	
INOXML-4VA	0.75	1		44	43	41	38	36	32	27	22	16	10	
INOXML-5VA	0.9	1.2	H	55	54	52	50	47	43	37	30	22	13	
INOXML-6VA	1.1	1.5		66	63	60	57	54	49	43	35	26	16	6
INOXML-8VA	1.5	2		88	84	80	76	72	65	57	48	37	25	12
INOXML-10VA	2.2	3		110	104	99	93	87	80	71	61	48	34	20

### OVERALL & INSTALLATION DIMENSIONS

Model	Inlet/Outlet (Inch)	PACKAGE DIMENSIONS & G.W.			
		A	B	H	Kg
INOXML-2VA	1"X1"	425	205	230	11
INOXML-3VA	1"X1"	450	205	230	12
INOXML-4VA	1"X1"	475	205	230	13
INOXML-5VA	1"X1"	500	205	230	14
INOXML-6VA	1"X1"	555	240	250	18
INOXML-8VA	1"X1"	605	240	250	20
INOXML-10VA	1"X1"	660	240	250	22

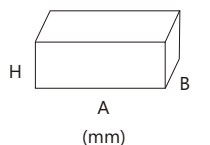

# SCM2

## CENTRIFUGAL PUMP

### OPERATING LIMITATIONS

- » Max ambient temperature up to 40°C
- » Max fluid temperature up to 80°C
- » Max pressure up to 10 bar
- » Installed in a covered area, protected against the weather.

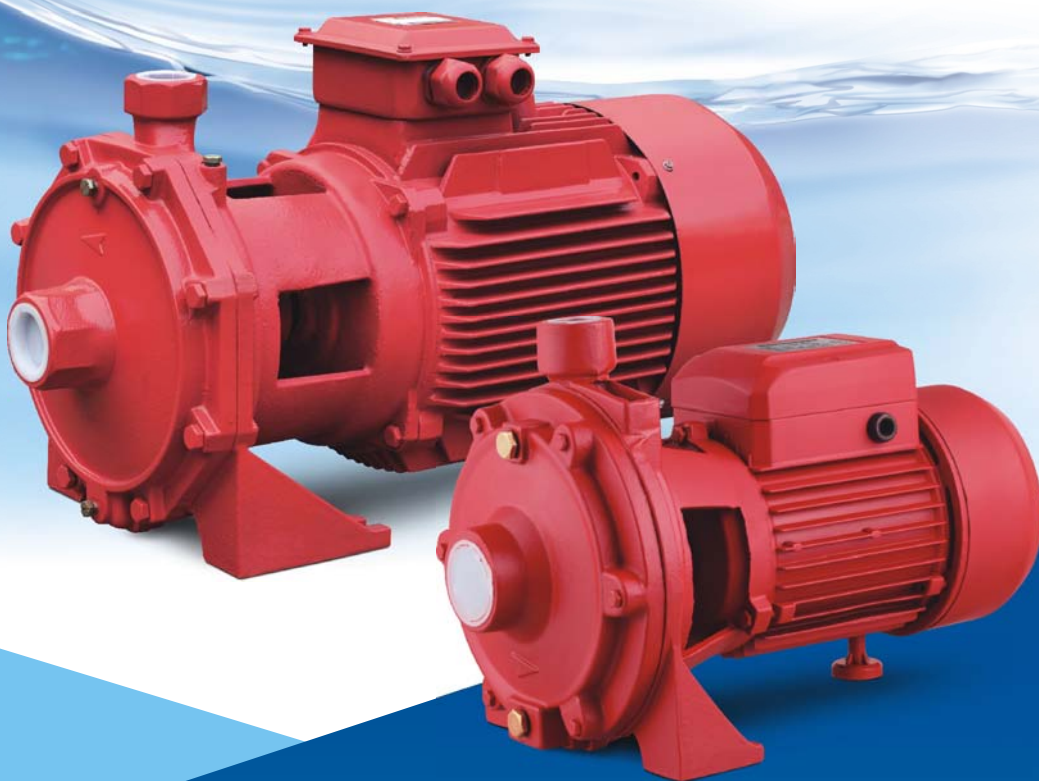

### APPLICATIONS AND INSTALLATION

The SCM2 series are coupled with two back to back brass impellers, it is suitable for higher discharge head which hard to reach by single impeller centrifugal pumps. suitable for civil and industrial uses to pump clean water and chemically non-aggressive liquid. particularly be used for increasing the supply pressure, feeding boilers and fire-fighting.

### CONSTRUCTION FEATURES

- » Pump body: Cast iron
- » Motor housing: Cast iron
- » Shaft: 45#Steel / Stainless welding steel
- » Impeller: Two brass
- » Motor: Closed, Externally ventilated
- » Insulation class: F
- » Protection class: IP44 / IP54
- » Duty: Continuously rated
- » Mechanical seal: Ceramic steatite / Metalized carbon

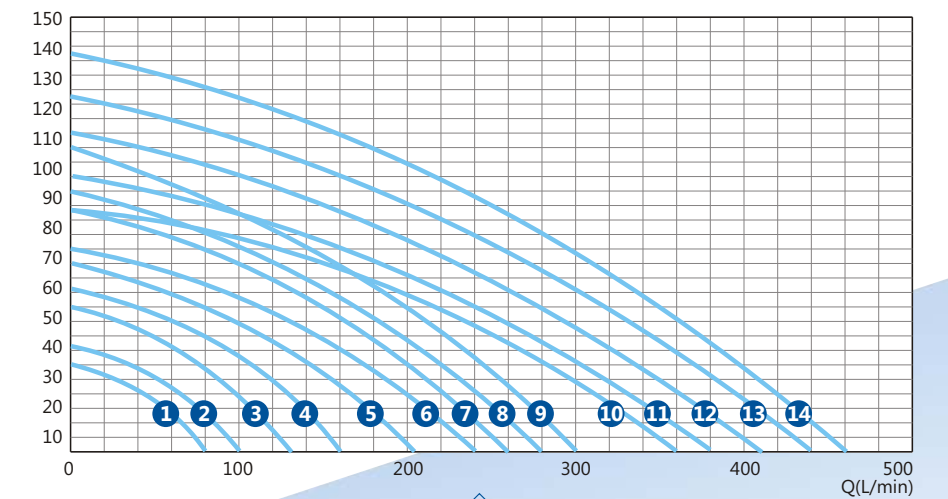
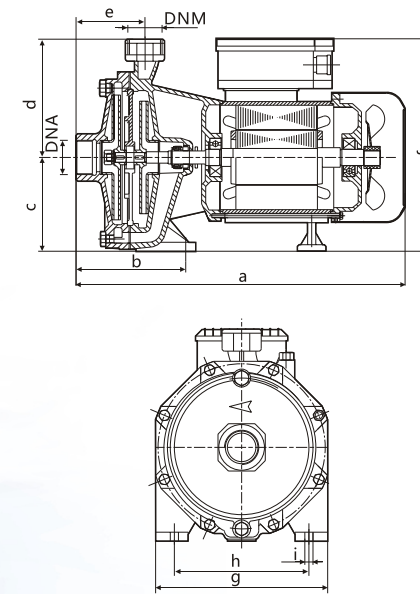

- ① SCM2-32 ② SCM2-40 ③ SCM2-52 ④ SCM2-60 ⑤ SCM2-68  
⑥ SCM2-70 ⑦ SCM2-80 ⑧ SCM2-90 ⑨ SCM2-100 ⑩ SCM2-80A  
⑪ SCM2-90A ⑫ SCM2-100A ⑬ SCM2-110 ⑭ SCM2-120

### TECHNICAL DATA

Model	Dimensions (mm)											
	DNA	DNM	a	L1	L2	L3	L4	H1	H2	W1	W2	S
SCM2-32	1"	1"	65	65	349	349	0	96	138	180	138	10
SCM2-40	1"	1"	65	65	349	349	0	96	138	180	138	10
SCM2-52	1.25"	1"	65	385	223	223	16	115	153	215	175	12
SCM2-60	1.5"	1"	65	385	223	223	16	115	153	215	175	12
SCM2-68	1.5"	1.25"	72	445	235	235	23	125	160	230	185	14
SCM2-70	1.5"	1.25"	77	530	302	302	24.5	140	170	260	210	14
SCM2-80	2"	1.25"	77	530	302	302	24.5	140	170	260	210	14
SCM2-90	2"	1.25"	83	595	323	323	24.5	150	185	275	220	14
SCM2-100	2"	1.25"	83	595	323	323	24.5	150	185	275	220	14
SCM2-80A	2"	1.25"	83	595	323	323	24.5	150	185	275	220	14
SCM2-90A	2"	1.25"	83	595	323	323	24.5	150	185	275	220	14
SCM2-100A	2"	1.25"	83	595	323	323	24.5	150	185	275	220	14
SCM2-110	2"	1.5"	102	745	415	415	28	180	210	310	255	18
SCM2-120	2"	1.5"	102	745	415	415	28	180	210	310	255	18

### OVERALL & INSTALLATION DIMENSIONS

Model	Power		V	R.P.M	Q.Max (L/min)	H.Max (m)	S.Head (m)	Kg
	HP	kW						
SCM2-32	0.75	0.55	220	2850	80	30	9	15.5
SCM2-40	1	0.75	220	2850	100	36	9	18.8
SCM2-52	1.5	1.1	220/380	2850	130	50	9	23.5
SCM2-60	2	1.5	220/380	2850	160	56	9	25.5
SCM2-68	3	2.2	220/380	2850	205	65	9	31
SCM2-70	4	3	380	2850	240	70	9	39
SCM2-80	5.5	4	380	2850	260	84	9	42.5
SCM2-90	7.5	5.5	380	2880	280	90	9	59
SCM2-100	10	7.5	380	2880	300	105	9	63
SCM2-80A	10	7.5	380	2900	360	85	9	68
SCM2-90A	12.5	9.5	380	2900	380	95	9	82
SCM2-100A	15	11	380	2920	410	110	9	85
SCM2-110	17.5	13	380	2920	440	124	9	110
SCM2-120	20	15	380	2920	460	135	9	120

The normal power standard is 220/50Hz single phase, 230/400V/50Hz three phase. Other voltages, frequencies, higher or lower liquid or ambient temperatures and materials are available on request.

# PERIPHERAL PUMP



# PERIPHERAL PUMP

## FUNCTIONING PRINCIPLE

These series are peripheral pumps, with peripheral impeller containing numerous radial blades in its edge. The particular shape of the blades rapidly transfers radial re-circulation motion rapidly to the fluid on entry to the pump, between the impeller blades and the double channel, machined on each side of the pump body, since numerous blades help transfer energy, the fluid pressure increases progressively and gain high pressures relative and its curves are steep particularly. They have various appearances and motor shells to the different operating requirements. They are reliable, economical and simple to use.

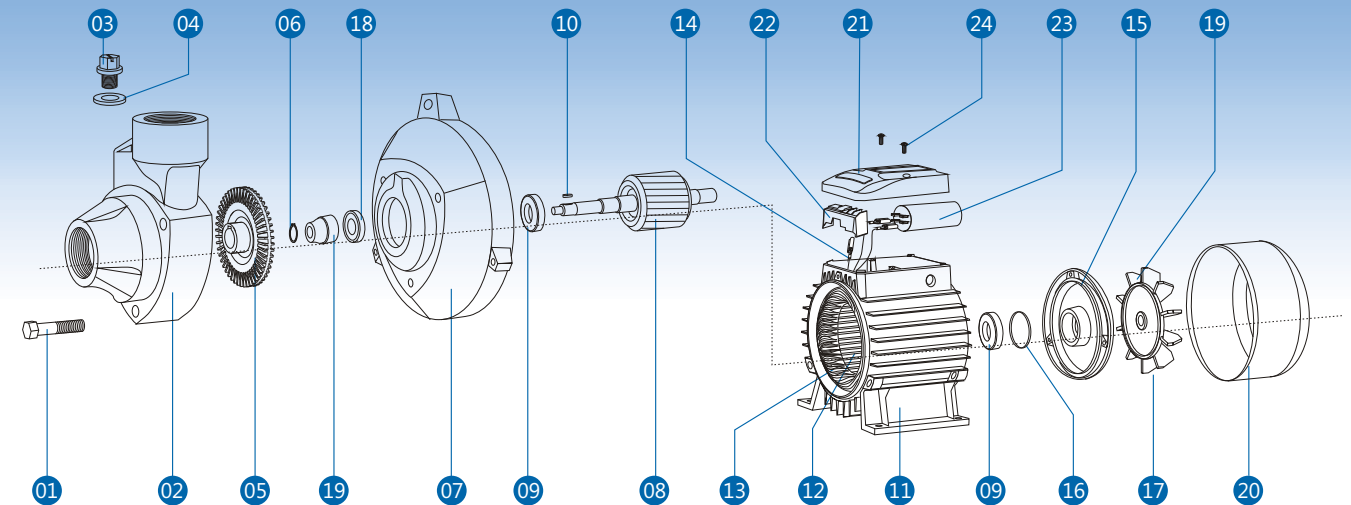

NO.	Name	NO.	Name	NO.	Name	NO.	Name
01	Screw	08	Motor Rotor	15	Motor End Cover	22	Terminal Block
02	Pump Body	09	Ball Bearing	16	Spring Washer	23	Capacitor
03	Flit Plug Screw	10	Locking unit	17	Screw	24	Screw
04	Seal	11	Motor Body	18	Mechanical Seal		
05	Impeller	12	Stator	19	Fan		
06	Locking Ring	13	Stator Coil	20	Fan Cover		
07	Motor Front Cover	14	Connection Wire	21	Terminal Cover		

# QB/PKM

## PERIPHERAL PUMP

### OPERATING LIMITATIONS

- » Max ambient temperature up to 40°C
- » Max fluid temperature up to 80°C
- » Max pressure up to 10 bar
- » Installed in a covered area, protected against the weather.



### APPLICATIONS AND INSTALLATION

The QB/PKM series are peripheral pumps, with peripheral impeller containing numerous radial blades in its edge, suitable for pumping clean water and chemically non-aggressive liquid. They have relatively simple construe and are very economical, reliable and safe. It is widely used for household and domestic applications such as water supply from wells and pools, pressure boosting, garden sprinkling, washing booths etc.

### CONSTRUCTION FEATURES

- » Pump body: Cast iron T-Eletrophoresis
- » Motor housing: Aluminum
- » Shaft: 45#Steel / Stainless welding steel
- » Impeller: Brass
- » Motor: Closed, Externally ventilated
- » Insulation class: F
- » Protection class: IP44 / IP54
- » Duty: Continuously rated
- » Mechanical seal: Ceramic steatite / Metalized carbon

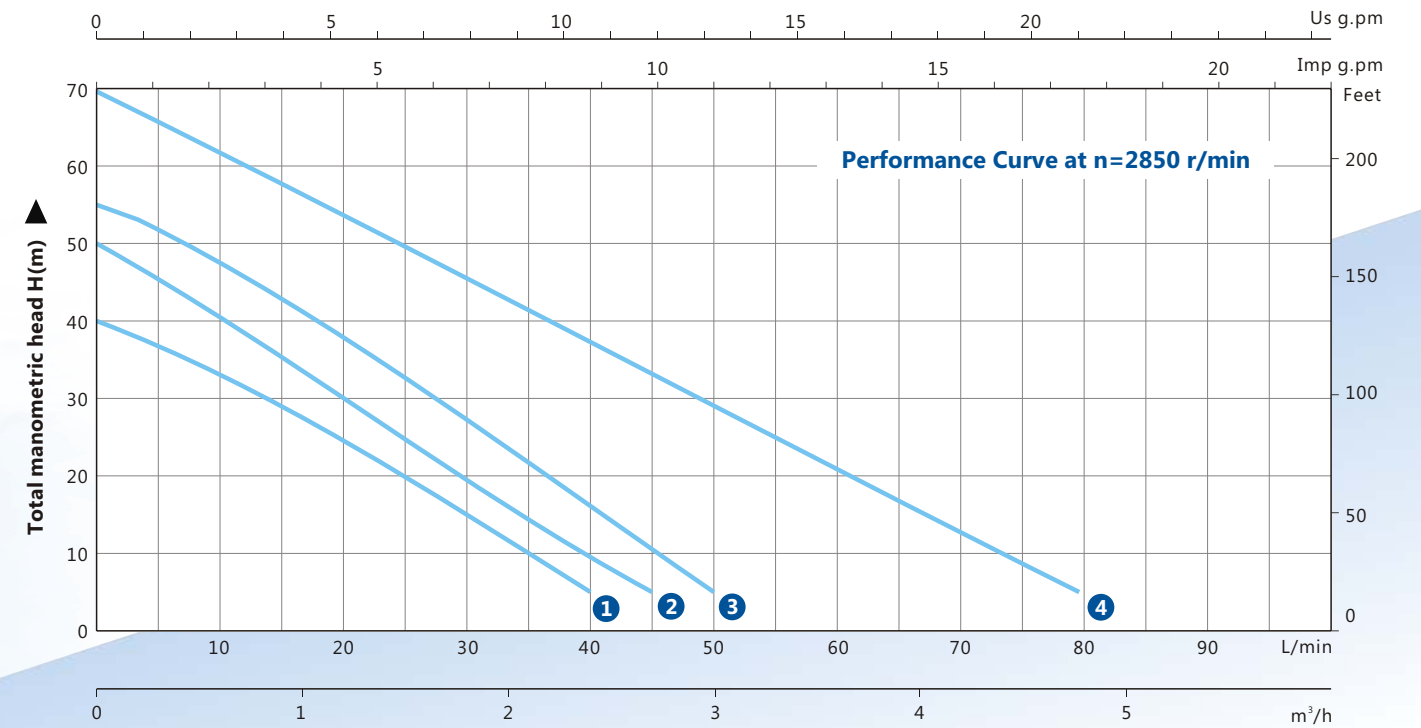

① QB/PKM-60 ② QB/PKM-70 ③ QB/PKM-80 ④ QB/PKM-90

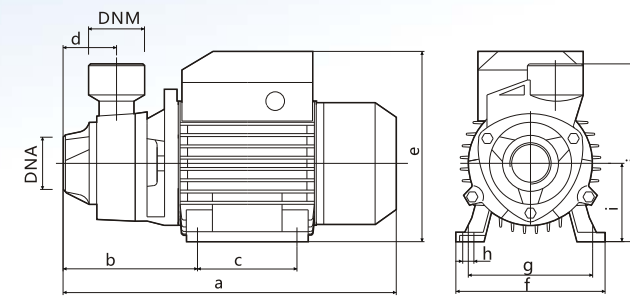

### TECHNICAL DATA (220~240V/50HZ, 2850rpm)

Model	Single-phase Motor			n=2850r/min		
	Input max kW	Output Power kW	Current A	Q.max L/min	H.max m	Suct.max m
QB/PKM-60	0.55	0.37	2.5	35	35	
QB/PKM-70	0.80	0.55	3.8	45	40	9
QB/PKM-80	1.10	0.75	5.2	50	50	
QB/PKM-90	1.50	1.10	7.0	60	60	

Other voltages and frequencies available on request.

### OVERALL & INSTALLATION DIMENSIONS

Model	DIMENSIONS (mm)														PACKAGE DIMENSIONS & G.W.						
	DNA		DNM		a	b	c	d	e	f	g	h	i	j	k	l	m	A	B	H	kg
	Inch	mm	Inch	mm																	
QB/PKM-60	1"	25	1"	25	265	110	80	45	151	118	100	10	63	138	--	--	--	285	150	180	5.5
QB/PKM-70	1"	25	1"	25	305	122	90	50	181	136	112	10	71	150	--	--	--	320	180	200	9.5
QB/PKM-80	1.5"	40	1.5"	40	305	122	90	50	181	136	112	10	71	150	--	--	--	320	180	200	10.0
QB/PKM-90	1.5"	40	1.5"	40	380	138	100	68	182	180	162	10	80	156	--	--	--	415	190	230	18.0

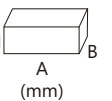

# PM/KPM

## PERIPHERAL PUMP

### OPERATING LIMITATIONS

- » Max ambient temperature up to 40°C
- » Max fluid temperature up to 80°C
- » Max pressure up to 10 bar
- » Installed in a covered area, protected against the weather.

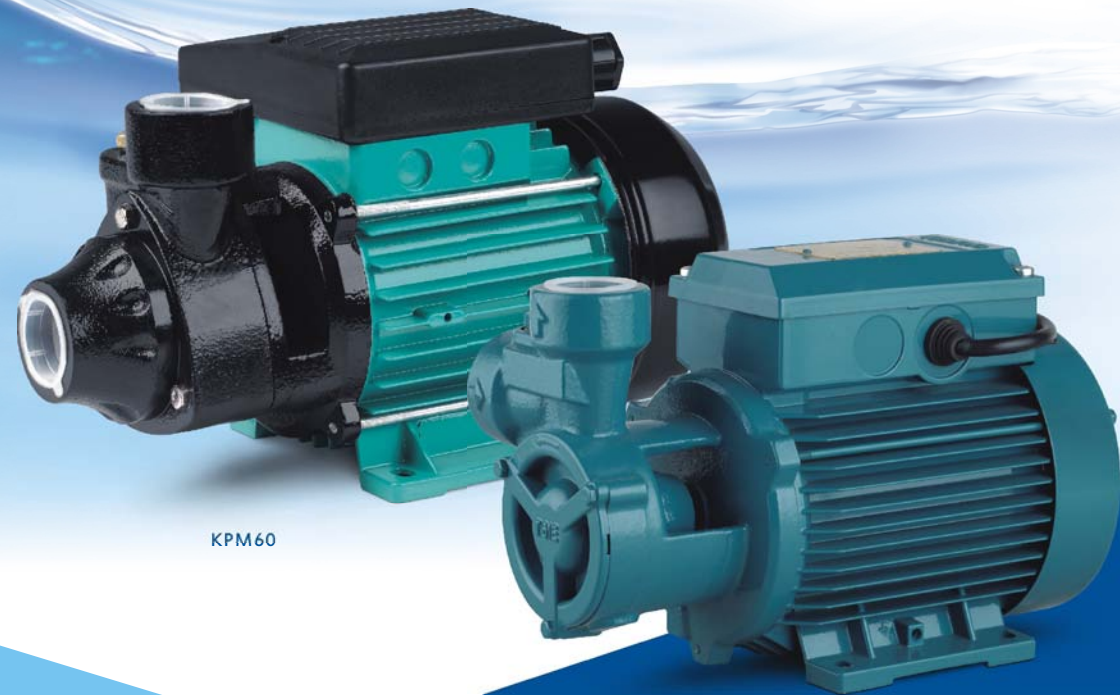

KPM60

DB-60C

### APPLICATIONS AND INSTALLATION

The PM/KPM series are peripheral pumps, with peripheral impeller containing numerous radial blades in its edge, suitable for pumping clean water and chemically non-aggressive liquid. They have relatively simple construe and are very economical, reliable and safe. It is widely used for household and domestic applications such as water supply from wells and pools, pressure boosting, garden sprinkling, washing booths etc.

### CONSTRUCTION FEATURES

- » Pump body: Cast iron T-Eletrophoresis
- » Motor housing: Aluminum
- » Shaft: 45#Steel / Stainless welding steel
- » Impeller: Brass
- » Motor: Closed, Externally ventilated
- » Insulation class: F
- » Protection class: IP44 / IP54
- » Duty: Continuously rated
- » Mechanical seal: Ceramic steatite / Metalized carbon

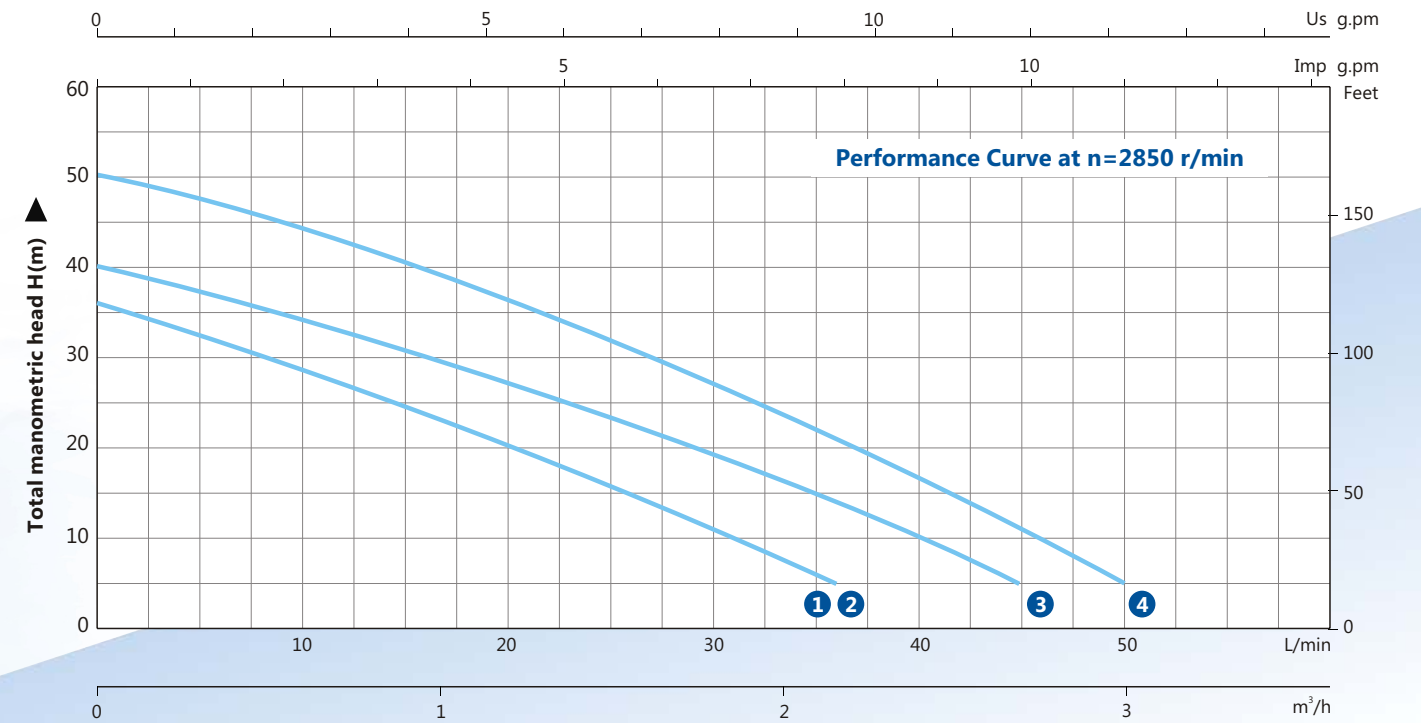

① DB-60C ② PM45/KPM60 ③ PM50/KPM70 ④ PM60/KPM80

### TECHNICAL DATA (220~240V/50HZ, 2850rpm)

Model	Single-phase Motor			n=2850r/min		
	Input max kW	Output Power kW	Current A	Q.max L/min	H.max m	Suct.max m
DB-60C	0.50	0.37	2.50	36	36	
PM45/KPM60	0.50	0.37	2.50	36	36	9
PM50/KPM70	0.80	0.55	3.80	45	40	
PM60/KPM80	1.10	0.75	5.20	50	50	

Other voltages and frequencies available on request.

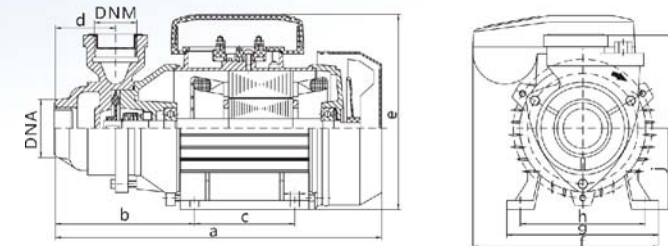

### OVERALL & INSTALLATION DIMENSIONS

Model	DIMENSIONS (mm)															PACKAGE DIMENSIONS & G.W.					
	DNA		DNM		a	b	c	d	e	f	g	h	i	j	k	l	m	A	B	H	kg
	Inch	mm	Inch	mm																	
DB-60C	1"	25	1"	25	260	115	80	51	156	150	120	98	9	63	143	--	--	285	150	185	5.8
PM45/KPM60	1"	25	1"	25	260	115	80	51	156	150	120	98	9	63	143	--	--	285	150	185	5.8
PM50/KPM70	1"	25	1"	25	305	120	90	55	176	155	136	112	10	71	152	--	--	320	180	200	9.6
PM60/KPM80	1.5"	40	1.5"	40	305	120	90	55	176	155	136	112	10	71	152	--	--	320	180	200	10.2

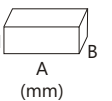

### OPERATING LIMITATIONS

- » Max ambient temperature up to 40°C
- » Max fluid temperature up to 80°C
- » Max pressure up to 10 bar
- » Installed in a covered area, protected against the weather.



### APPLICATIONS AND INSTALLATION

The TPS series are self-priming peripheral pumps, with peripheral impeller containing numerous radial blades in its edge, self-priming because of the particular design of the pump body which is with a small tank, water is thrown outwards by centrifugal motion caused by the impeller. Then the water rotates with the impeller, generating high pressure. These pumps have a compact size and are very economical, finding the most different operating requirements such as: supply water from well, pool and so on, increase the water pressure in the pipe, garden sprinkling or clean washing.

### CONSTRUCTION FEATURES

- » Pump body: Cast iron
- » Motor housing: Aluminum
- » Shaft: 45#Steel / Stainless welding steel
- » Impeller: Brass
- » Motor: Closed, Externally ventilated
- » Insulation class: F
- » Protection class: IP44 / IP54
- » Duty: Continuously rated
- » Mechanical seal: Ceramic steatite / Metalized carbon

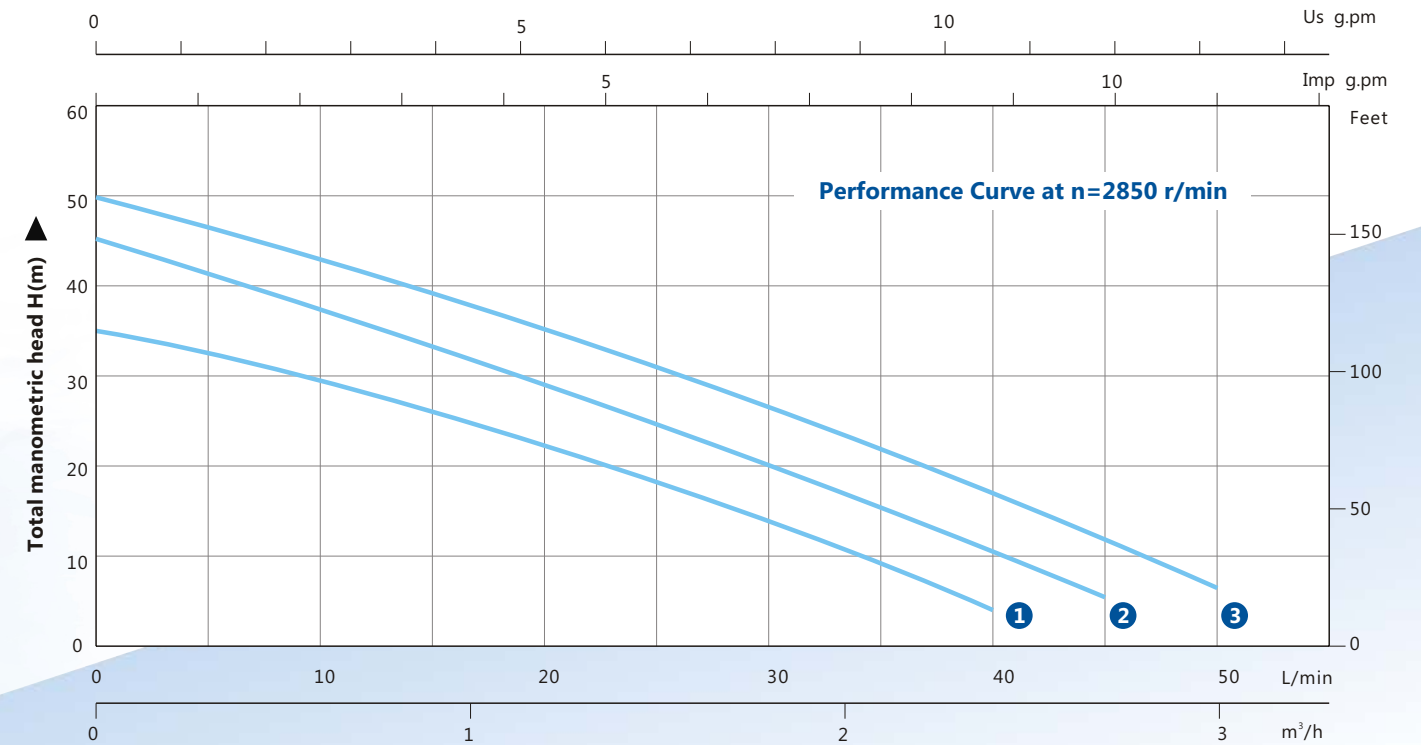

1 TPS-60 2 TPS-70 3 TPS-80

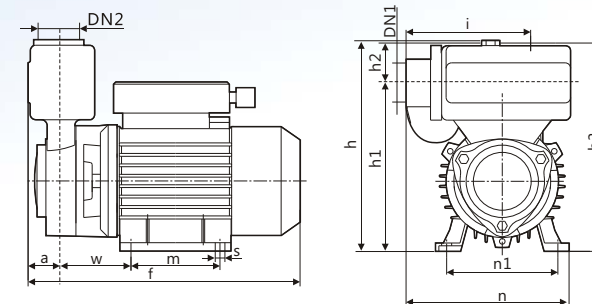

### TECHNICAL DATA (220~240V/50HZ, 2850rpm)

Model	Single-phase Motor			n=2850r/min		
	Input max kW	Output Power kW	Current A	Q.max L/min	H.max m	Suct.max m
TPS-60	0.55	0.37	2.5	40	35	
TPS-70	0.80	0.55	3.8	45	45	9
TPS-80	1.10	0.75	5.2	50	50	

Other voltages and frequencies available on request.

### OVERALL & INSTALLATION DIMENSIONS

Model	DIMENSIONS (mm)														PACKAGE DIMENSIONS & G.W.					
	DNA		DNM		a	f	h	h1	h2	h3	i	m	n	n1	w	s	A	B	H	kg
	Inch	mm	Inch	mm																
TPS-60	1"	25	1"	25	29	230	192	156	34	190	110	80	150	100	55	7	267	175	235	6.8
TPS-70	1"	25	1"	25	29	260	200	164	34	198	110	90	160	112	62	7	327	205	260	8.8
TPS-80	1"	25	1"	25	29	260	200	164	34	198	110	90	160	112	62	7	327	205	260	9.2

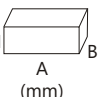

## PERIPHERAL SELF PRIME PUMP

### OPERATING LIMITATIONS

- » Max ambient temperature up to 40°C
- » Max fluid temperature up to 80°C
- » Max pressure up to 10 bar
- » Installed in a covered area, protected against the weather.

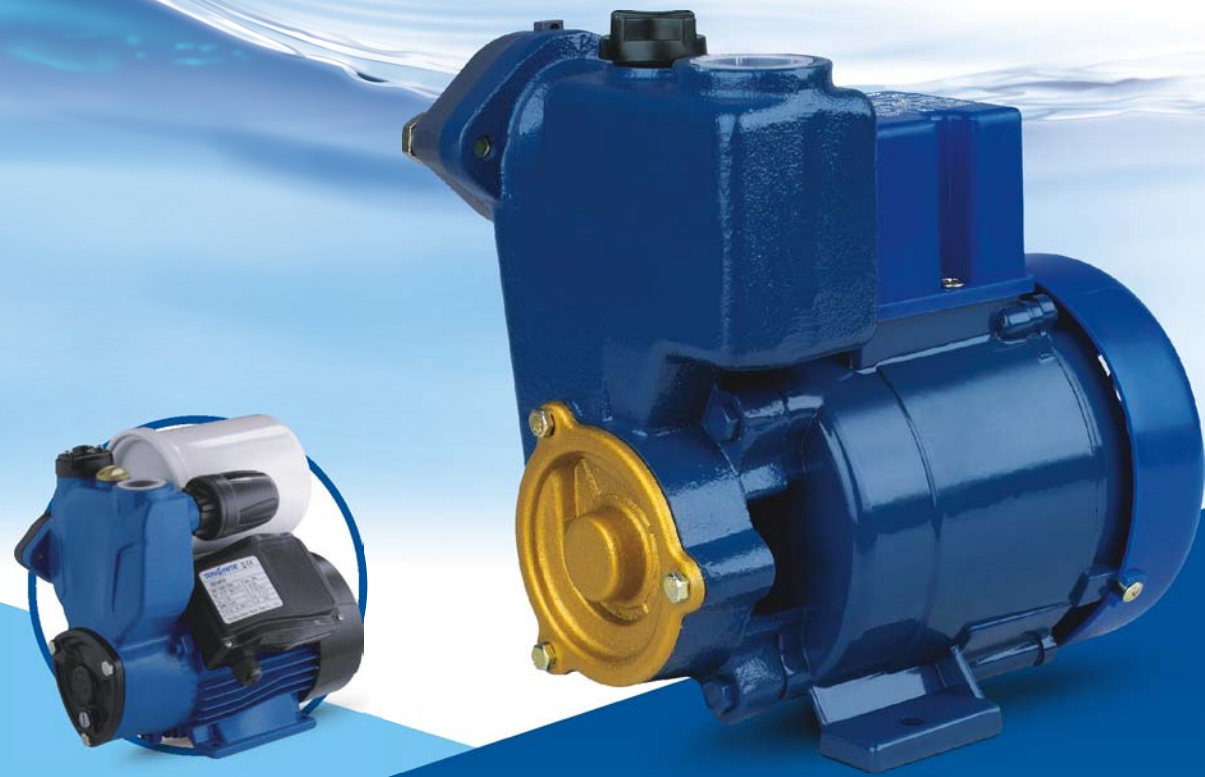

AUPS130T



AUPS130

### APPLICATIONS AND INSTALLATION

The GP series are self-priming peripheral pumps, with peripheral impeller containing numerous radial blades in its edge, self-priming because of the particular design of the pump body which is with a small tank, water is thrown outwards by centrifugal motion caused by the impeller. Then the water rotates with the impeller, generating high pressure. These pumps have a compact size and are very economical, finding the most different operating requirements such as: supply water from well, pool and so on, increase the water pressure in the pipe, garden sprinkling or clean washing.

### CONSTRUCTION FEATURES

- » Pump body: Cast iron
- » Motor housing: Aluminum / Carbon steel
- » Shaft: 45#Steel / Stainless steel
- » Impeller: Brass
- » Motor: Closed, Externally ventilated
- » Insulation class: F
- » Protection class: IP44 / IP54
- » Duty: Continuously rated
- » Mechanical seal: Ceramic steatite / Metalized carbon

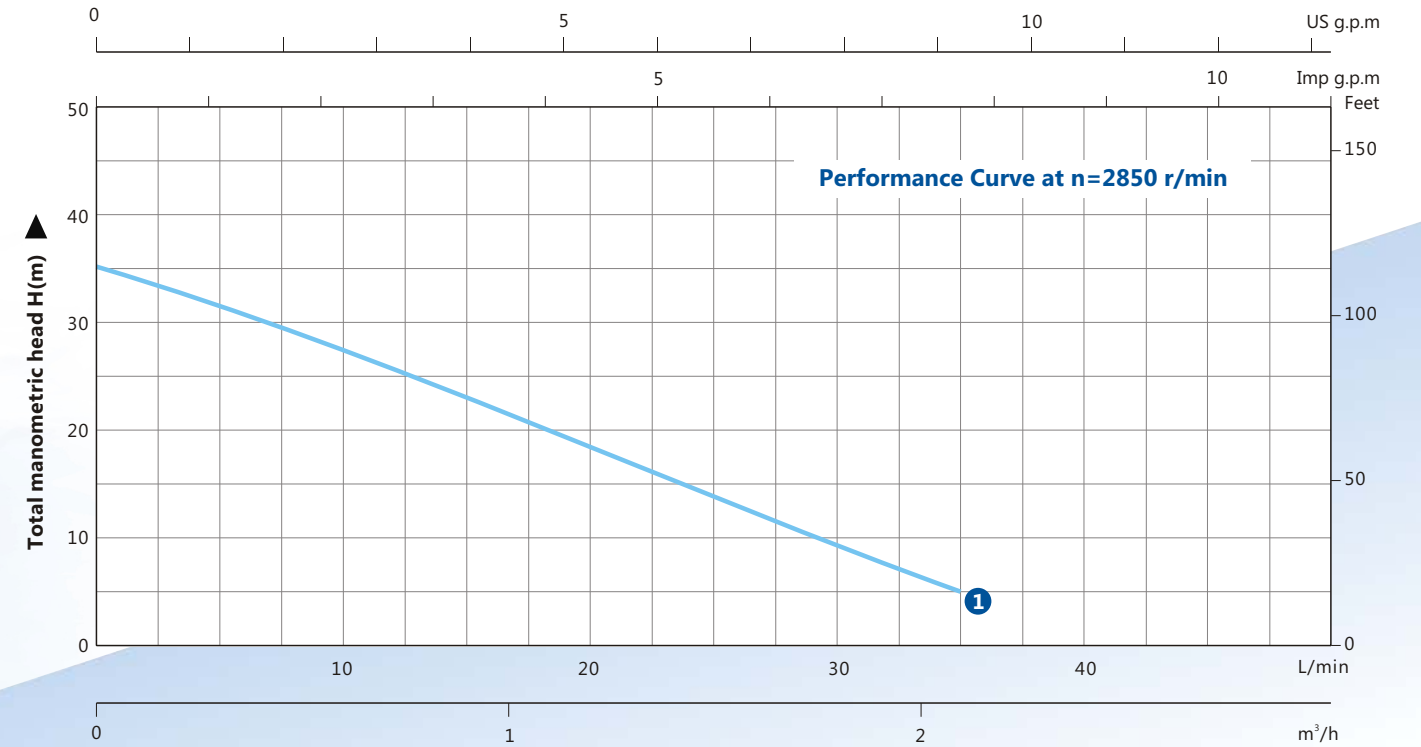

1 GP-125A

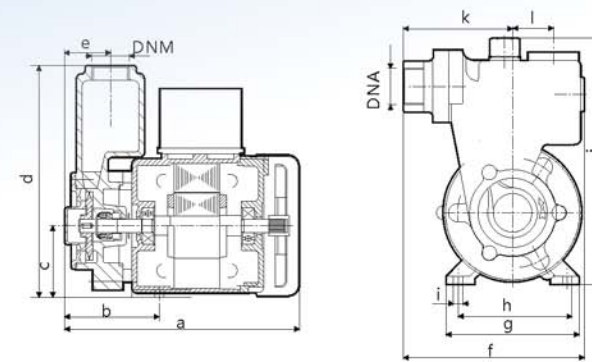

### TECHNICAL DATA (220~240V/50HZ, 2850rpm)

Model	Single-phase Motor			n=2850r/min		
	Input max kW	Output Power kW	Current A	Q.max L/min	H.max m	Suct.max m
GP-125A	0.25	0.125	1.30	35	35	9

Other voltages and frequencies available on request.

### OVERALL & INSTALLATION DIMENSIONS

Model	DIMENSIONS (mm)														PACKAGE DIMENSIONS & G.W.						
	DNA		DNM		a	b	c	d	e	f	g	h	i	j	k	l	m	A	B	H	kg
	Inch	mm	Inch	mm																	
GP-125A	1"	25	1"	25	198	84	71	202	40	151	121	105	6	220	83	40	--	265	175	243	6.8

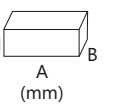

# WPG

## SERIES AIR-COOLED GASOLINE WATER PUMP

### WPG FEATURES

- » Powered by air-cooled 4-stroke OHV gasoline engine
- » Pressure casting aluminum pump body
- » High quality and mechanical sealed equipment
- » Self sucking and high-pressure
- » Compact in structure and light weight



### FEATURE

- » The efficient light weight aluminum die-cast pumps in 2", 3", 4" inlet & outlet delivers big volume water.
- » Powered by air-cooled 4-stroke OHV gasoline engine
- » The highly effective mechanical seal with a special carbon
- » Ceramic provides extra durability
- » The entire unit is protected by a sturdy steel rollover pipe frame

### TECHNICAL DATA

	Item	Type	WPG50	WPG80	WPG100	WPG40	WPG50
PUMP	Pipe Dia		1.5"x1.5"(40mm)	2"x2"(50mm)	2"x2"(50mm)	3"x3"(80mm)	4"x4"(100mm)
	Head Max(m)		24	30	26	30	30
	Suction Head(m)		5	5	8	8	8
	Quantity Max(m <sup>3</sup> /h)		14	18	36	60	90
	Speed(rpm)		5500	5500	3600	3600	3600
ENGINE	Engine model		ESE1E45F-2	ESE1E45F	ESE168FA	ESE168FA	ESE173F
	Max. output (kW)		1.18/5500	1.18/5500	5.5(4.1)/3600	5.5(4.1)/3600	8.0(5.9)/3600
	Fuel tank capacity(L)		1.2	1.2	3.6	3.6	6
	Bore x stroke (mm)		45X40	45X40	68X45	68X45	73x58
	Compressing ratio		7.5:1	7.5:1	8.5:1	8.5:1	8.2:1
	Engine model		Single cylinder air cooling, 2-stroke		Inclined;1-cylinder;4-stroke		
	Air cleaner model		Semi-dry;oil bath;dual;silent;cyclone				
	Ignition model		CDI				
Starting model				Recoil			
DIMENSION	Package dimensions(mm)		345X330X375	390X310X360	515X415X425	525x415x470	635x480x590
	N.W./G.W.(kg)		15/16	16/17	28/30	31/33	48/50
	20FTP volume (set)		714	714	280	280	168

# WPD

## SERIES AIR-COOLED DIESEL WATER PUMP

### Features

- » Powered by air-cooled direct injection 4-stroke diesel engines
- » Aluminum alloy high pressure casting
- » High quality and mechanical sealed equipment
- » Self suction and high-pressure structure, lightweight
- » Large fuel tank ensures hours of continuous running



### TECHNICAL DATA

	Pump Model	WPD50C(L)	WPD80BC(L)	WPD80BC(L)	WPD100BC(L)
PUMP	Pipe Dia	2"x2"(50mm)	3"x3"(80mm)	4"x4"(100mm)	1.5"x1.5"(40mm)
	Head Max.(m)	15	13	16	42
	Suction Head(m)	8	8	8	8
	Quantity Max(m <sup>3</sup> /h)	22	36	64	8
ENGINE	Model	170FP	178FP	186FP	178FP
	Type	Single-cylinder, Vertical, 4-stroke, Forced air-cooled, Direct-injection			
	Start Mode	Recoil and hand-operated			
	Fuel tank Capacity (L)	2.5	3.5	5.5	3.5
DIMENSION	Package Dimensions (mm)	525X410X515	570X445X550	645X480X600	560X430X515
	N.W./G.W. (KG)	35/37	52/54	69/72	43/45
	20 FTP Volume (set)	220	220	108	200

SELF-PRIMING JET  
PUMP

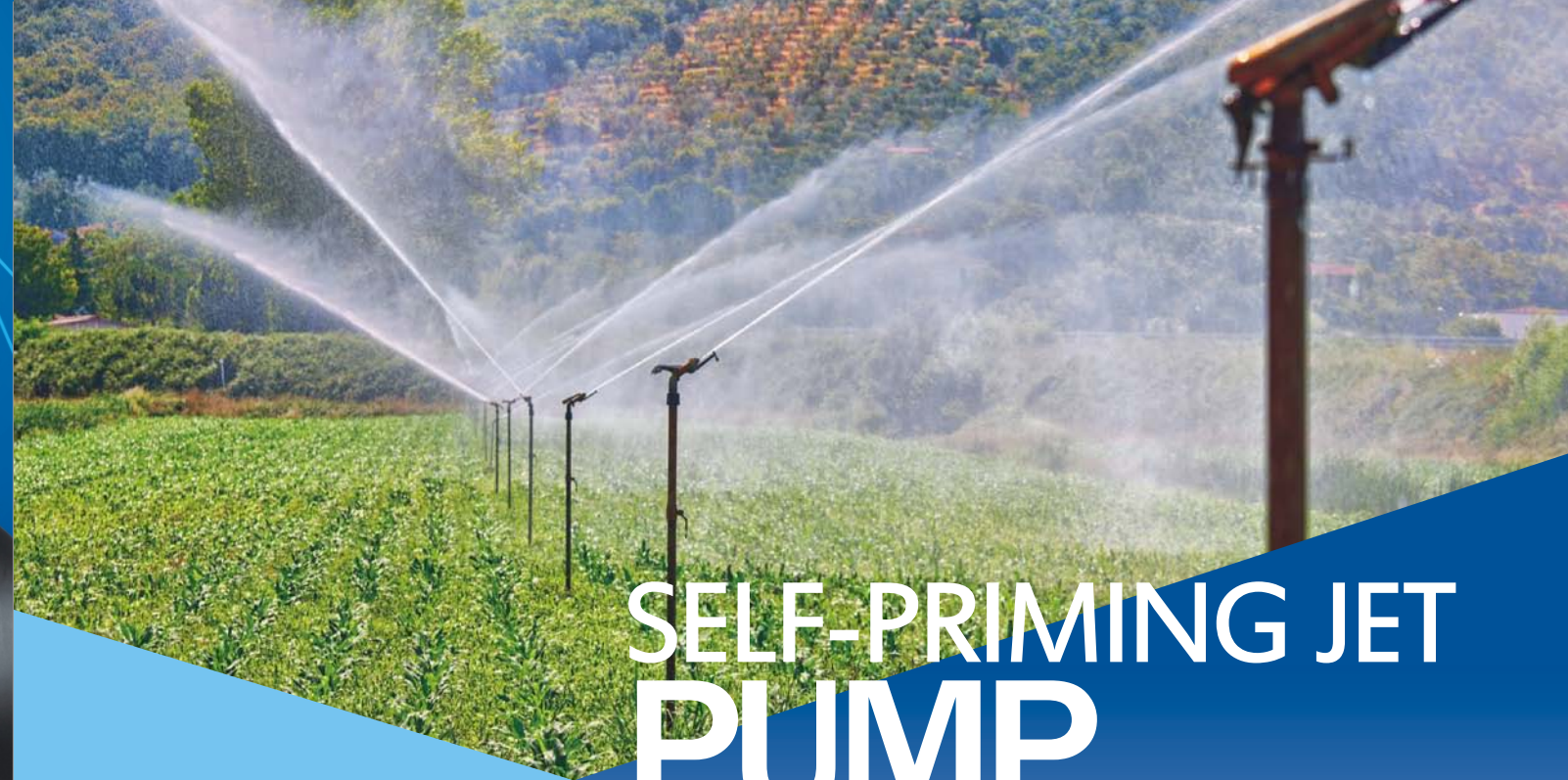

# SELF-PRIMING JET PUMP

## FUNCTIONING PRINCIPLE

These series are mostly SELF-PRIMING JET PUMPS. Self-priming is achieved using an ejector, housed in the pump body. The total delivered by the closed centrifugal impeller is sent only partly to the delivery opening, the remaining water is re-circulated through the ejector, which is connected to the suction chamber and generates the necessary vacuum to self-prime the pump. When the pump is started up, the water in the pump body circulates through the ejector and transfers any air from the suction to the delivery chamber, expelling it through the delivery piping. At the same time the vacuum thus generated causes water to rise in the suction piping, thus self-priming the pump. Since the self-priming system operates continuously, these pumps are practically unaffected even by the presence of large amounts of entrained air in the fluid being pumped. They are designed to auto-control system with booster, pressure switch and gauges.

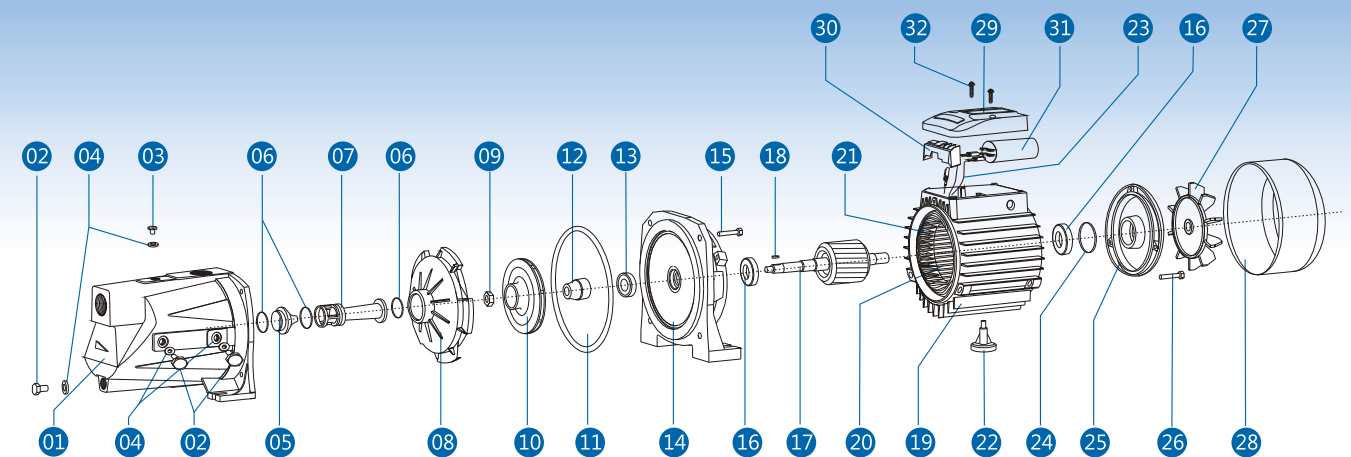

NO.	Name	NO.	Name	NO.	Name	NO.	Name	NO.	Name
01	Pump body	08	Diffusor	15	Screw	22	Motor Foot	29	Terminal cover
02	Coper Screw	09	Locking nut	16	Ball bearing	23	Connection Wire	30	Terminal block
03	Flit plug Screw	10	Impeller	17	Motor Rotor	24	Spring Washer	30	Capacitor
04	Seal	11	O Ring	18	Shaft Key	25	Motor End Cover	32	Screw
05	Nozzel	12	Mechanical seal	19	Motor Body	26	Screw		
06	Jet Seal	13	Mechanical seal	20	Stator	27	Fan		
07	Jet pipe	14	Motor front cover	21	Stator Coil	28	Fan cover		

# JET-C

## SELF-PRIMING JET PUMP

### OPERATING LIMITATIONS

- » Max ambient temperature up to 40°C
- » Max fluid temperature up to 80°C
- » Max pressure up to 10 bar
- » Installed in a covered area, protected against the weather.

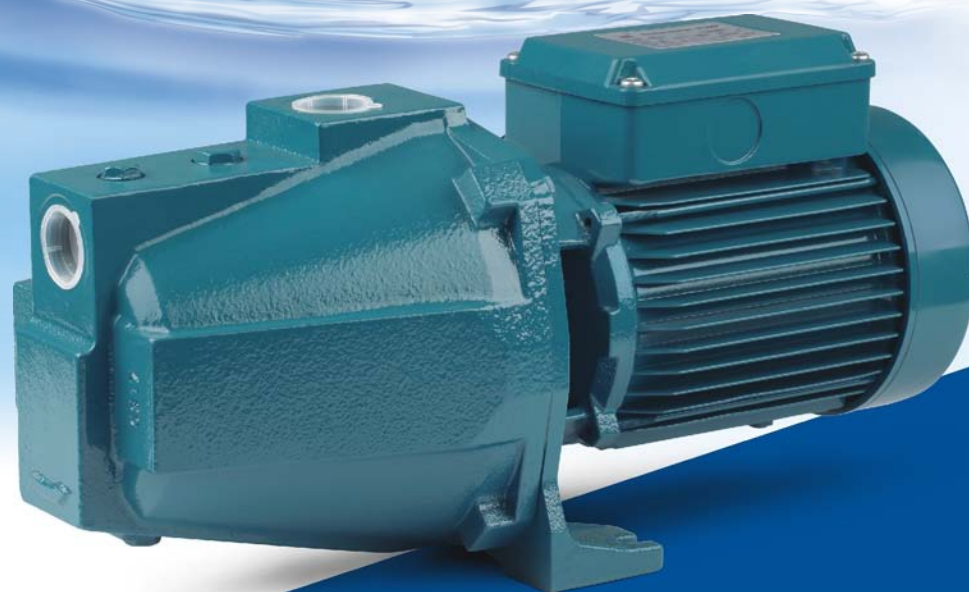

### APPLICATIONS AND INSTALLATION

The JET series are injection type clean water pumps, which are composed of a centrifugal pump and a nozzle, have the advantages of beautiful design, self-priming in short time, reliable performance, high head and deep suction. They are suitable for pumping clean water and non-aggressive liquid. They are particularly suitable for domestic applications such as supply water from well, pool etc, the automatic distribution of water by surge tanks and pressure switch, gardening, and pressure boosting etc.

### CONSTRUCTION FEATURES

- » Pump body: Cast iron
- » Motor housing: Aluminum
- » Shaft: 45#Steel / Stainless welding steel
- » Impeller: Brass / Stainless steel
- » Motor: Closed, Externally ventilated
- » Insulation class: F
- » Protection class: IP44 / IP54
- » Duty: Continuously rated
- » Mechanical seal: Ceramic steatite / Metalized carbon

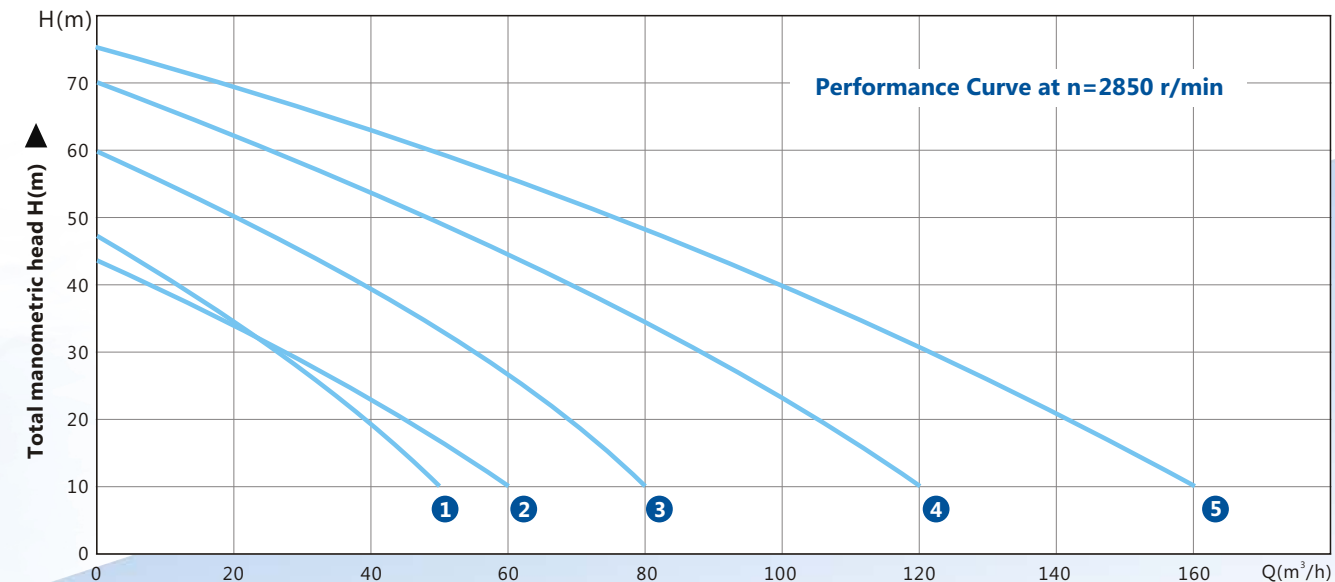

① JET-3C    ② JET-4C    ③ JET-5C    ④ JET-6C    ⑤ JET-7C

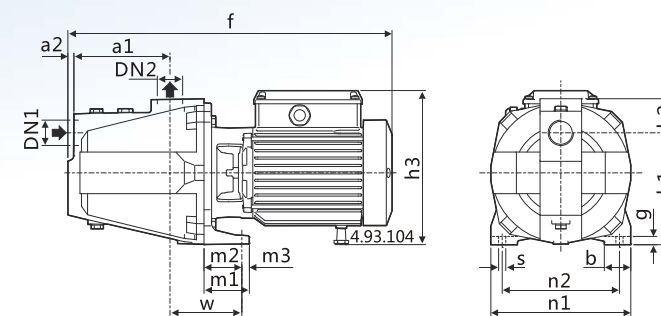

### TECHNICAL DATA (220~240V/50HZ, 2850rpm)

Model	Single-phase Motor			n=2850r/min		
	Input max kW	Output Power kW	Current A	Q.max L/min	H.max m	Suct.max m
JET-3/C	0.9	0.55	3.2	50	48	
JET-4/C	1.0	0.75	4.2	60	42	
JET-5/C	1.47	1.1	5.2	80	60	9
JET-6/C	2	1.5	7.2	120	70	
JET-7/C	2.9	2.2	9.4	160	75	

Other voltages and frequencies available on request.

### OVERALL & INSTALLATION DIMENSIONS

Model	DIMENSIONS (mm)																	
	DN1	DN2	a1	a2	fM	h1	h2	H	m1	m2	m3	n1	n2	b	s	w	g	kg
JET-3/C	G1	G1	127	8	430	150	43	207	60	52	8	185	155	35	9.5	100	11	18.4
JET-4/C	G1	G1	127	8	430	150	43	207	60	52	8	185	155	35	9.5	100	11	19.2
JET-5/C	G 1 1/2	G1	160	10	560	165	57	197	60	50	10	215	175	40	11.5	115	11	29.2
JET-6/C	G1 1/2	G1	160	10	560	165	57	197	60	50	10	215	175	40	11.5	115	11	30.8
JET-7/C	G1 1/2	G1	160	10	600	165	57	197	60	50	10	215	175	40	11.5	115	11	31.3

# JETS

## SELF-PRIMING JET PUMP

### OPERATING LIMITATIONS

- » Max ambient temperature up to 40°C
- » Max fluid temperature up to 80°C
- » Max pressure up to 10 bar
- » Installed in a covered area, protected against the weather.



JETS-100H

JETS-100



INOXJET102M

### APPLICATIONS AND INSTALLATION

The JETS series are injection type clean water pumps, which are composed of a centrifugal pump and a nozzle, have the advantages of beautiful design, self-priming in short time, reliable performance, high head and deep suction. They are suitable for pumping clean water and non-aggressive liquid. They are particularly suitable for domestic applications such as supply water from well, pool etc, the automatic distribution of water by surge tanks and pressure switch, gardening, and pressure boosting etc.

### CONSTRUCTION FEATURES

- » Pump body: 304 Stainless steel
- » Motor housing: Aluminum
- » Shaft: Stainless welding steel
- » Impeller: Brass / PPO / Stainless steel
- » Motor: Closed, Externally ventilated
- » Insulation class: F
- » Protection class: IP44 / IP54
- » Duty: Continuously rated
- » Mechanical seal: Ceramic steatite / Metalized carbon

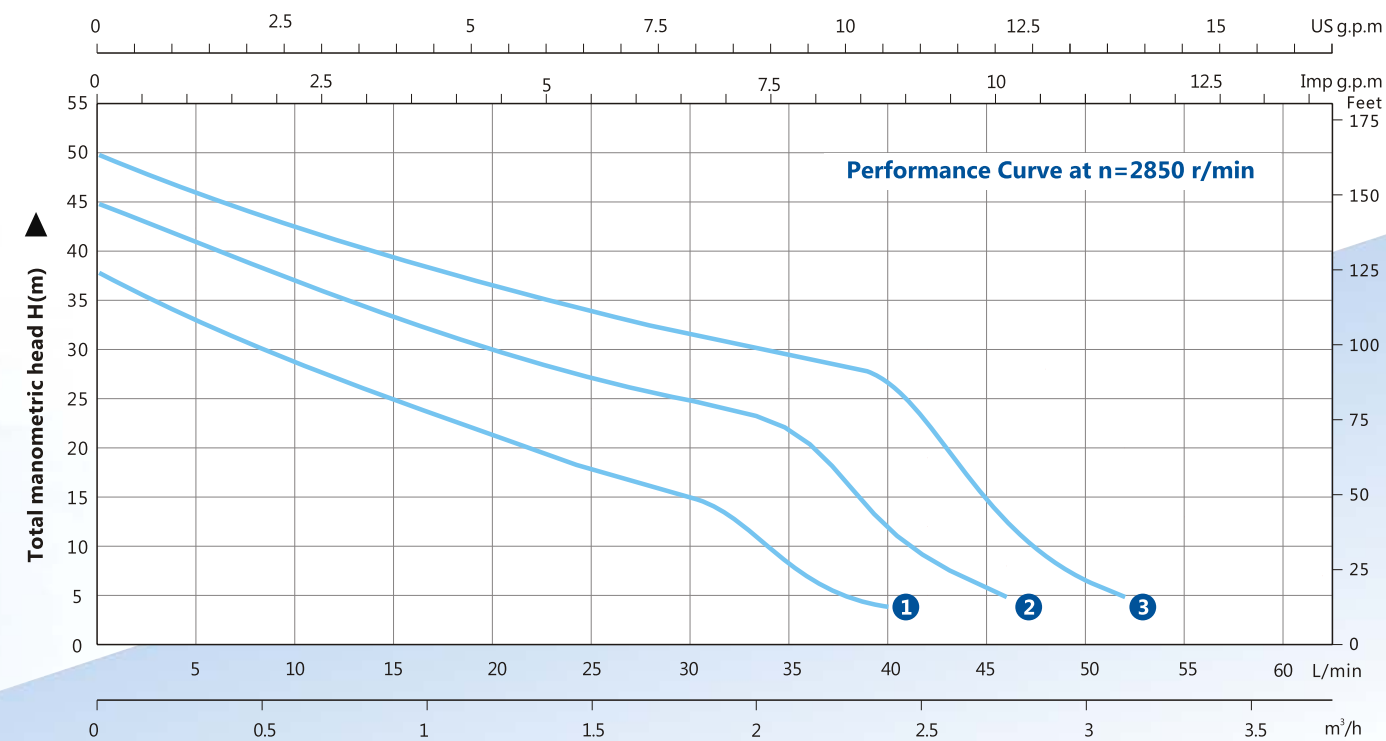

① JETS-60 ② JETS-80 ③ JETS-100

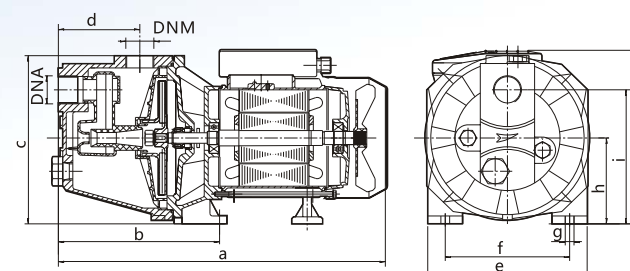

### TECHNICAL DATA (220~240V/50HZ, 2850rpm)

Model	Single-phase Motor			n=2850r/min			
	Input max kW	Output Power kW	Current A	Q.max L/min	H.max m	Suct.max m	
JETS-60	0.68	0.46	3.2	40	38		
JETS-80	0.88	0.60	4.2	46	45	9	
JETS-100	1.10	0.75	5.2	52	50		

Other voltages and frequencies available on request.

### OVERALL & INSTALLATION DIMENSIONS

Model	DIMENSIONS (mm)														PACKAGE DIMENSIONS & G.W.						
	DNA		DNM		a	b	c	d	e	f	g	h	i	j	k	l	m	A	B	H	kg
	Inch	mm	Inch	mm																	
JETS-60	1"	25	1"	25	378	177	195	91	180	137	10	104	151	200	--	--	--	420	210	220	13.6
JETS-80	1"	25	1"	25	378	177	195	91	180	137	10	104	151	200	--	--	--	420	210	220	14.6
JETS-100	1"	25	1"	25	378	177	195	91	180	137	10	104	151	200	--	--	--	420	210	220	15.6

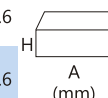

# JET-S/CAM

## SELF-PRIMING JET PUMP

### OPERATING LIMITATIONS

- » Max ambient temperature up to 40°C
- » Max fluid temperature up to 80°C
- » Max pressure up to 10 bar
- » Installed in a covered area, protected against the weather.



JET-100S

CAM-60



CAM-100H  
OEM for SPERONI only



CAM-40T

### APPLICATIONS AND INSTALLATION

The JET series are injection type clean water pumps, which are composed of a centrifugal pump and a nozzle, have the advantages of beautiful design, self-priming in short time, reliable performance, high head and deep suction. They are suitable for pumping clean water and non-aggressive liquid. They are particularly suitable for domestic applications such as supply water from well, pool etc, the automatic distribution of water by surge tanks and pressure switch, gardening, and pressure boosting etc.

### CONSTRUCTION FEATURES

- » Pump body: Cast iron T-Electrophoresis
- » Motor housing: Aluminum
- » Shaft: 45#Steel / Stainless welding steel
- » Impeller: Brass / PPO / Stainless steel
- » Motor: Closed, Externally ventilated
- » Insulation class: F
- » Protection class: IP44 / IP54
- » Duty: Continuously rated
- » Mechanical seal: Ceramic steatite / Metalized carbon

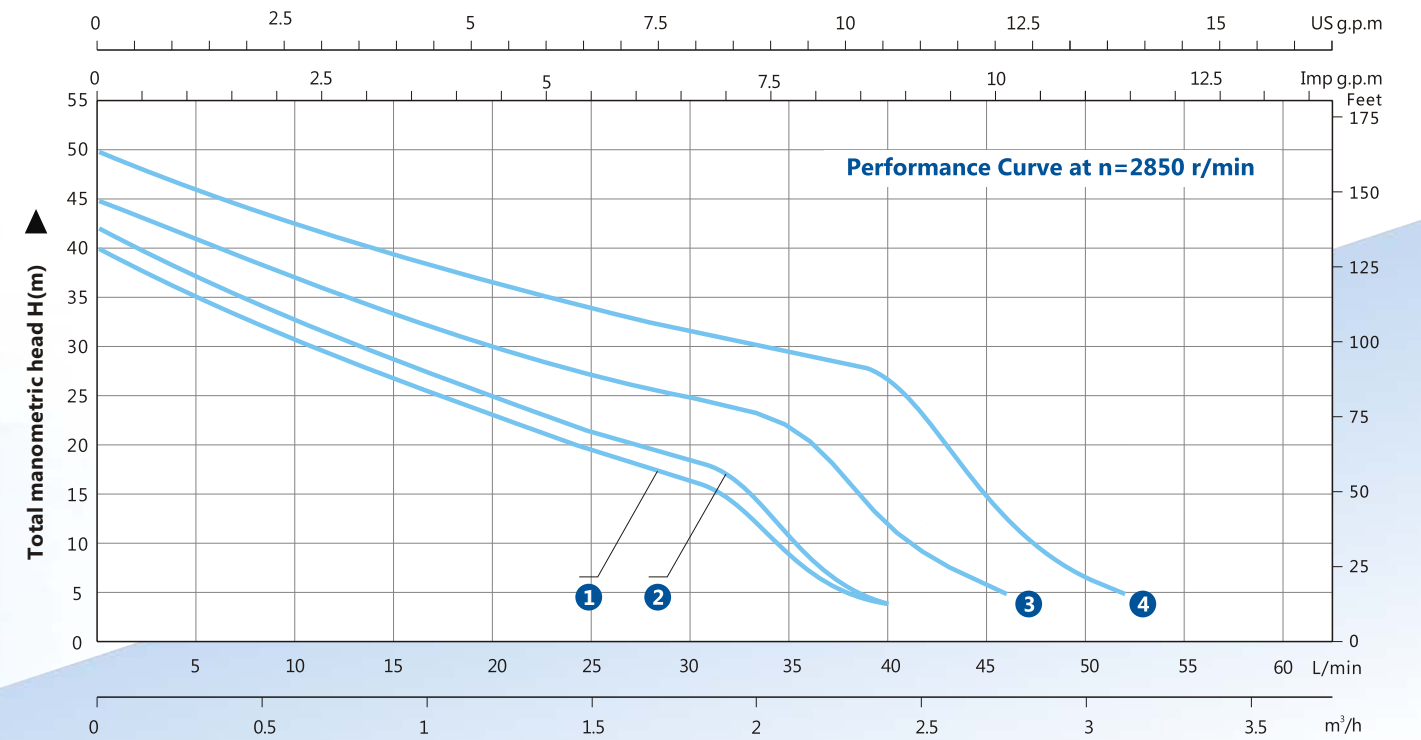

① CAM-40 ② JET-60S/CAM-60 ③ JET-80S/CAM-80 ④ JET-100S/CAM-100

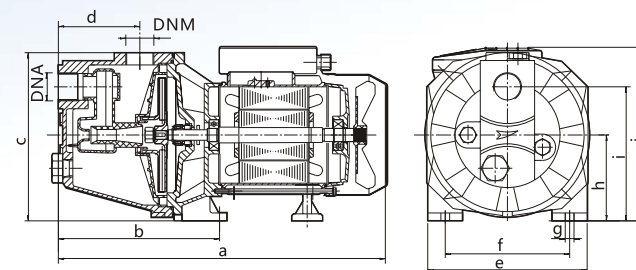

### TECHNICAL DATA (220~240V/50HZ, 2850rpm)

Model	Single-phase Motor			n=2850r/min		
	Input max kW	Output Power kW	Current A	Q.max L/min	H.max m	Suct.max m
CAM-40	0.5	0.37	2.8	40	40	
JET-60S/CAM-60	0.68	0.46	3.2	40	42	9
JET-80S/CAM-80	0.88	0.60	4.2	46	45	
JET-100S/CAM-100	1.10	0.75	5.2	52	50	

Other voltages and frequencies available on request.

### OVERALL & INSTALLATION DIMENSIONS

Model	DIMENSIONS (mm)														PACKAGE DIMENSIONS & G.W.						
	DNA		DNM		a	b	c	d	e	f	g	h	i	j	k	l	m	A	B	H	kg
	Inch	mm	Inch	mm																	
CAM-40	1"	25	1"	25	338	165	168	80	155	155	10	85	120	185	--	--	--	360	180	220	9.5
JET-60S/CAM-60	1"	25	1"	25	378	177	195	91	180	137	10	104	151	200	--	--	--	420	210	220	13.6
JET-80S/CAM-80	1"	25	1"	25	378	177	195	91	180	137	10	104	151	200	--	--	--	420	210	220	14.6
JET-100S/CAM-100	1"	25	1"	25	378	177	195	91	180	137	10	104	151	200	--	--	--	420	210	220	15.6

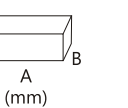

# JET-L/M80

## SELF-PRIMING JET PUMP

### OPERATING LIMITATIONS

- » Max ambient temperature up to 40°C
- » Max fluid temperature up to 80°C
- » Max pressure up to 10 bar
- » Installed in a covered area, protected against the weather.



JET-100L

M100



JET-100BH

### APPLICATIONS AND INSTALLATION

The JET series are injection type clean water pumps, which are composed of a centrifugal pump and a nozzle, have the advantages of beautiful design, self-priming in short time, reliable performance, high head and deep suction. They are suitable for pumping clean water and non-aggressive liquid. They are particularly suitable for domestic applications such as supply water from well, pool etc, the automatic distribution of water by surge tanks and pressure switch, gardening, and pressure boosting etc.

### CONSTRUCTION FEATURES

- » Pump body: Cast iron
- » Motor housing: Aluminum
- » Shaft: 45#Steel / Stainless welding steel
- » Impeller: Brass / PPO / Stainless steel
- » Motor: Closed, Externally ventilated
- » Insulation class: F
- » Protection class: IP44 / IP54
- » Duty: Continuously rated
- » Mechanical seal: Ceramic steatite / Metalized carbon

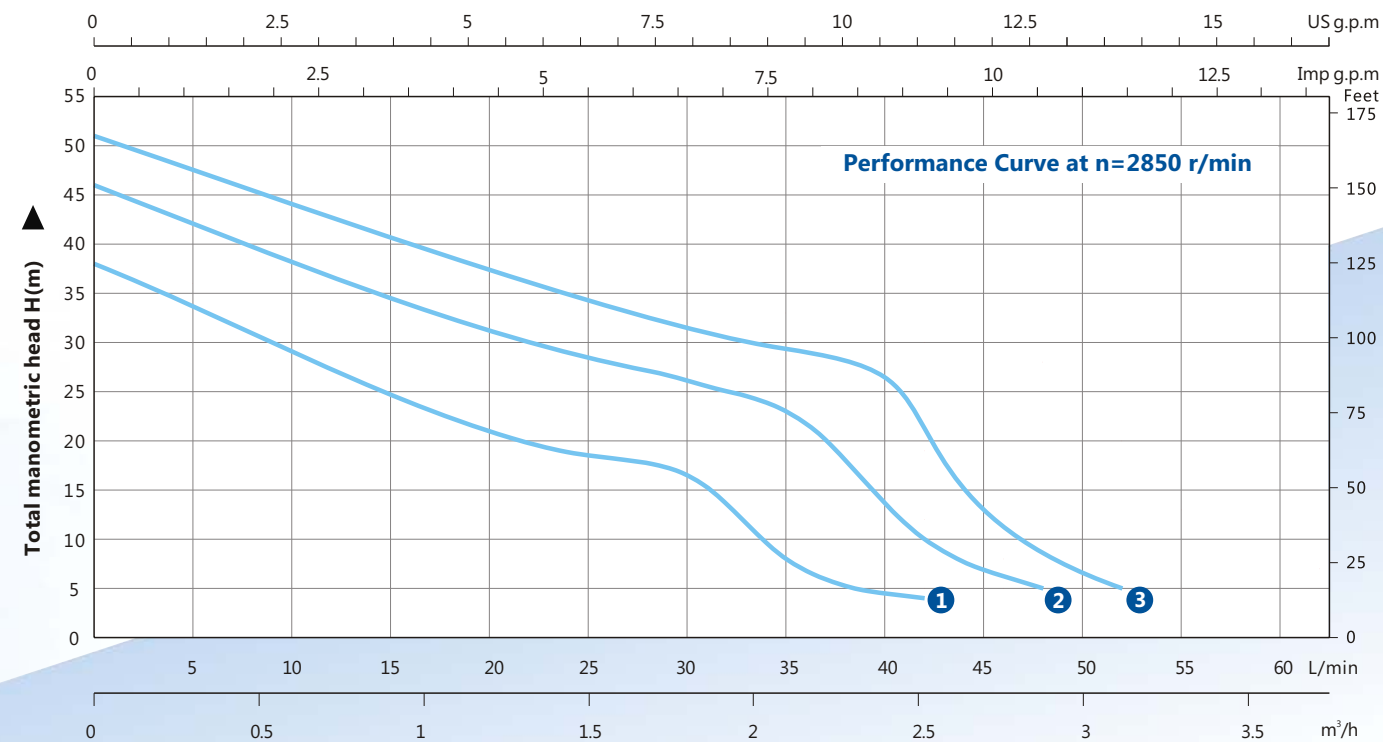

1 JET-60L/M60 2 JET-80L/M80 3 JET-100L/M100

### TECHNICAL DATA (220~240V/50HZ, 2850rpm)

Model	Single-phase Motor			n=2850r/min		
	Input max kW	Output Power kW	Current A	Q.max L/min	H.max m	Suct.max m
JET-60L/M60	0.68	0.46	3.2	42	38	
JET-80L/M80	0.88	0.60	4.2	48	46	9
JET-100L/M100	1.10	0.75	5.2	52	51	

Other voltages and frequencies available on request.

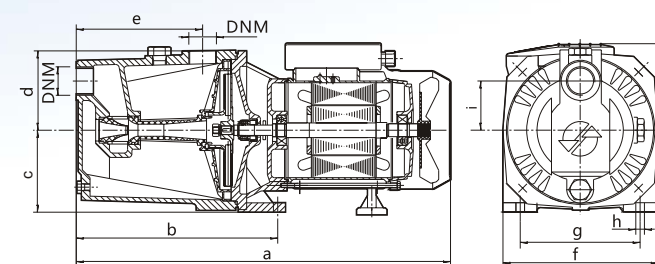

### OVERALL & INSTALLATION DIMENSIONS

Model	DIMENSIONS (mm)														PACKAGE DIMENSIONS & G.W.						
	DNA		DNM		a	b	c	d	e	f	g	h	i	j	k	l	m	A	B	H	kg
	Inch	mm	Inch	mm																	
JET-60L/M60	1"	25	1"	25	435	238	90	94	150	182	141	9	57	198	--	--	--	475	205	225	15.2
JET-80L/M80	1"	25	1"	25	435	238	90	94	150	182	141	9	57	198	--	--	--	475	205	225	16.2
JET-100L/M100	1"	25	1"	25	435	238	90	94	150	182	141	9	57	198	--	--	--	475	205	225	17.2

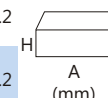

# JET-P/102M

## SELF-PRIMING JET PUMP

### OPERATING LIMITATIONS

- » Max ambient temperature up to 40°C
- » Max fluid temperature up to 80°C
- » Max pressure up to 10 bar
- » Installed in a covered area, protected against the weather.



JET-100P

JET-102M



JET-200M

### APPLICATIONS AND INSTALLATION

The JET series are injection type clean water pumps, which are composed of a centrifugal pump and a nozzle, have the advantages of beautiful design, self-priming in short time, reliable performance, high head and deep suction. They are suitable for pumping clean water and non-aggressive liquid. They are particularly suitable for domestic applications such as supply water from well, pool etc, the automatic distribution of water by surge tanks and pressure switch, gardening, and pressure boosting etc.

### CONSTRUCTION FEATURES

- » Pump body: cast iron
- » Motor housing: aluminum
- » Shaft: 45#steel / stainless welding steel
- » Impeller: brass / ppo / stainless steel
- » Motor: closed, externally ventilated
- » Insulation class: F
- » Protection class: IP44 / IP54
- » Duty: continuously rated
- » Mechanical seal: ceramic steatite / metalized carbon

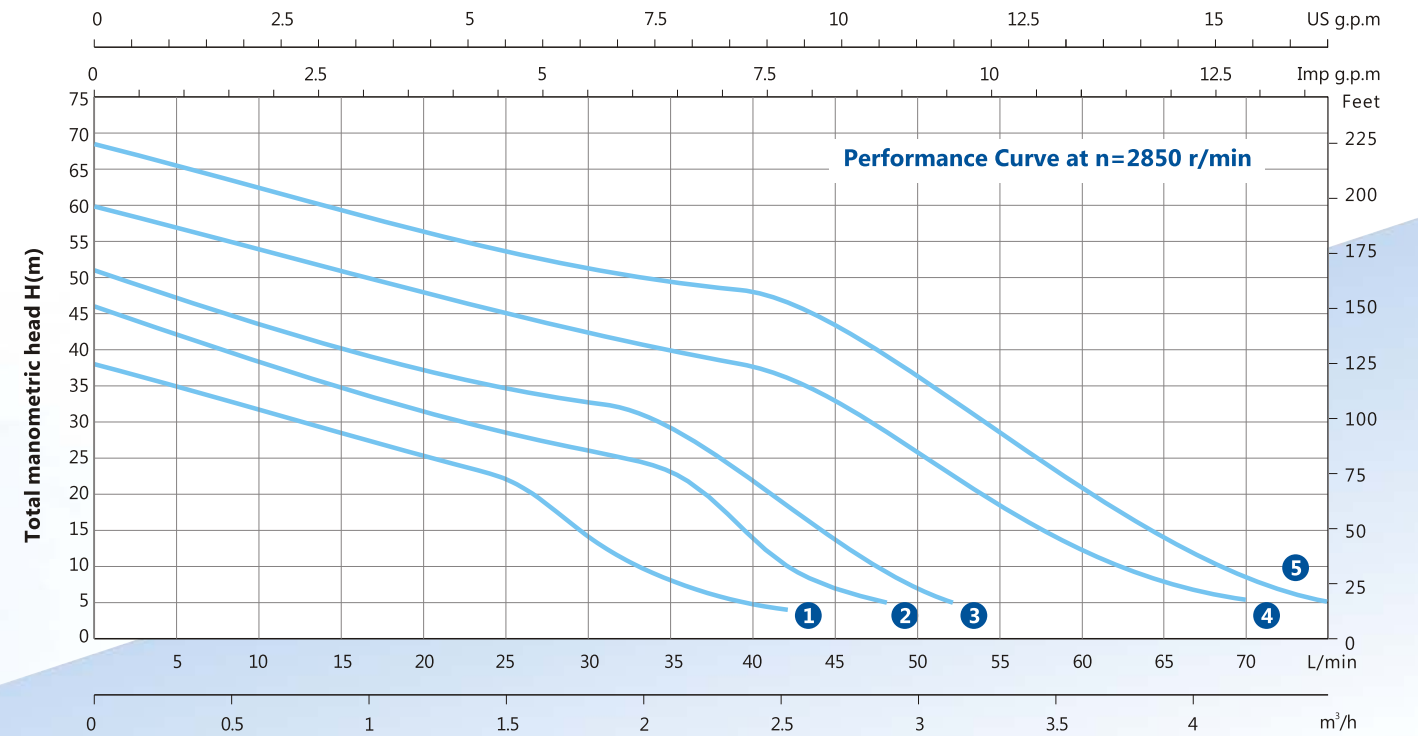

① JET-60P/82M ② JET-80P/92M ③ JET-100P/102M ④ JET120P/200M ⑤ JET140P/300M

### TECHNICAL DATA (220~240V/50HZ, 2850rpm)

Model	Single-phase Motor			n=2850r/min		
	Input max kW	Output Power kW	Current A	Q.max L/min	H.max m	Suct.max m
JET-60P/82M	0.68	0.46	3.2	42	38	
JET-80P/92M	0.88	0.60	4.2	48	46	
JET-100P/102M	1.10	0.75	5.2	52	51	9
JET120P/200M	1.6	1.1	7.2	70	60	
JET140P/300M	2	1.5	9.4	75	68	

Other voltages and frequencies available on request.

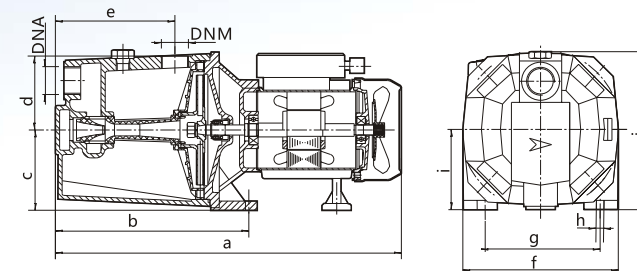

### OVERALL & INSTALLATION DIMENSIONS

Model	DIMENSIONS (mm)														PACKAGE DIMENSIONS & G.W.						
	DNA		DNM		a	b	c	d	e	f	g	h	i	j	k	l	m	A	B	H	kg
	Inch	mm	Inch	mm																	
JET-60P/82M	1"	25	1"	25	440	235	100	90	140	181	140	10	100	220	--	--	--	455	207	220	15.3
JET-80P/92M	1"	25	1"	25	440	235	100	90	140	181	140	10	100	220	--	--	--	455	207	220	16.3
JET-100P/102M	1"	25	1"	25	440	235	100	90	140	181	140	10	100	220	--	--	--	455	207	220	17.3
JET120P/200M	1.5"	40	1.25"	40	570	282	122	114	198	236	198	12	100	274	--	--	--	590	255	280	32.0
JET140P/300M	1.5"	40	1.25"	40	570	282	122	114	198	236	198	12	100	274	--	--	--	590	255	280	34.5

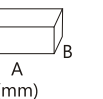

# JSW/JSP

## SELF-PRIMING JET PUMP

### OPERATING LIMITATIONS

- » Max ambient temperature up to 40°C
- » Max fluid temperature up to 80°C
- » Max pressure up to 10 bar
- » Installed in a covered area, protected against the weather.



JSW-10m

JSP-455

### APPLICATIONS AND INSTALLATION

The JSW/JSP series are injection type clean water pumps, which are composed of a centrifugal pump and a nozzle, have the advantages of beautiful design, self-priming in short time, reliable performance, high head and deep suction. They are suitable for pumping clean water and non-aggressive liquid. They are particularly suitable for domestic applications such as supply water from well, pool etc, the automatic distribution of water by surge tanks and pressure switch, gardening, and pressure boosting etc.

### CONSTRUCTION FEATURES

- » Pump body: Cast iron
- » Motor housing: Aluminum
- » Shaft: 45#Steel / Stainless steel
- » Impeller: Brass
- » Motor: Closed, Externally ventilated
- » Insulation class: F
- » Protection class: IP44 / IP54
- » Duty: Continuously rated
- » Mechanical seal: Ceramic steatite / Metalized carbon

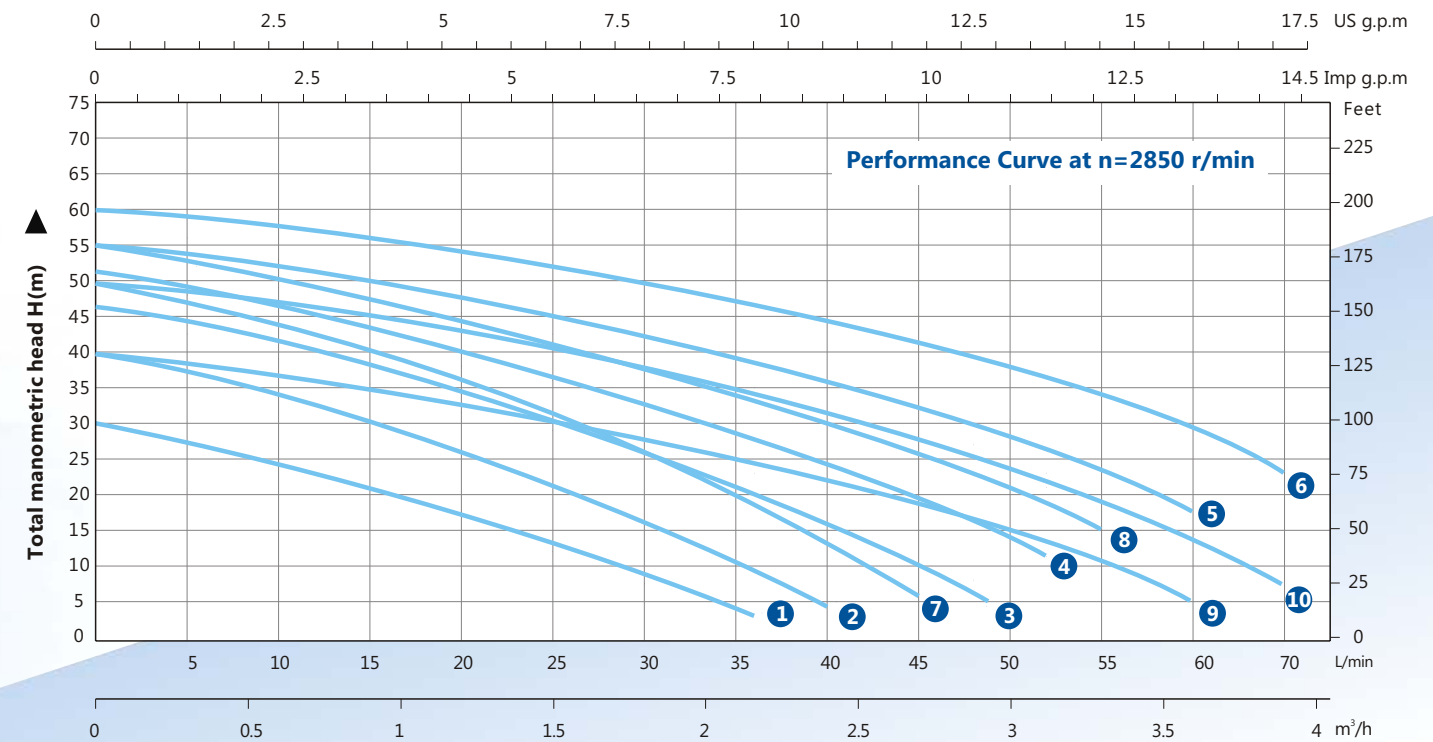

- ① JSP-100A ② JSP-255 ③ JSP-355A ④ JSP-455A ⑤ JSP-555  
⑥ JSP-655 ⑦ JSW-10h ⑧ JSW-15h ⑨ JSW-10m ⑩ JSW-15m

### TECHNICAL DATA (220~240V/50HZ, 2850rpm)

Model	Single-phase Motor			n=2850r/min		
	Input max kW	Output Power kW	Current A	Q.max L/min	H.max m	Suct.max m
JSP-100A	0.55	0.37	2.5	36	30	9
JSP-255	0.60	0.40	3.8	40	40	
JSP-355A	0.88	0.60	4.2	48	46	
JSP-455A	1.10	0.75	5.2	52	51	
JSP-555	1.50	1.10	7.0	60	55	
JSP-655	2.00	1.50	9.6	70	60	
JSW-10h	1.10	0.75	5.2	45	50	
JSW-15h	1.50	1.10	7.0	55	55	
JSW-10m	1.10	0.75	5.2	60	40	
JSW-15m	1.50	1.10	7.0	70	50	

Other voltages and frequencies available on request.

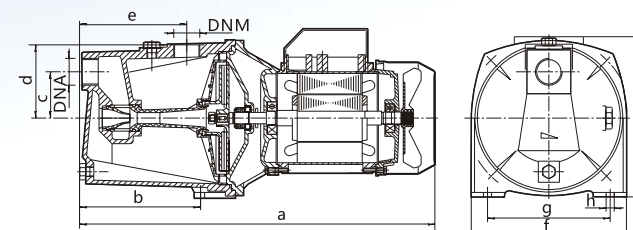

### OVERALL & INSTALLATION DIMENSIONS

Model	DIMENSIONS (mm)														PACKAGE DIMENSIONS & G.W.						
	DNA		DNM		a	b	c	d	e	f	g	h	i	j	k	l	m	A	B	H	kg
	Inch	mm	Inch	mm																	
JSP-100A	1"	25	1"	25	382	132	45	71	122	157	124	10	176	--	--	--	--	400	180	200	12.2
JSP-255	1"	15	1"	25	435	148	57	88	130	191	144	10	200	--	--	--	--	460	210	225	16.3
JSP-355A	1"	25	1"	25	435	148	57	88	130	191	144	10	200	--	--	--	--	460	210	225	16.3
JSP-455A	1"	25	1"	25	435	148	57	88	130	191	144	10	200	--	--	--	--	460	210	225	17.3
JSP-555	1.25"	30	1"	25	515	169	68	101	168	209	163	10	218	--	--	--	--	560	215	260	32.0
JSP-655	1.25"	30	1"	25	515	169	68	101	168	209	163	10	218	--	--	--	--	560	215	260	35.0
JSW 10h/m	1"	25	1"	25	395	133	97	91	112.5	182	142	10	205.5	55.5	--	--	--	455	207	225	16
JSW 15h/m	1"	25	1"	25	395	133	97	91	112.5	182	142	10	205.5	55.5	--	--	--	455	207	225	18

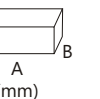

# JETDP/JDW

## SELF-PRIMING DEEP WELL PUMP

### OPERATING LIMITATIONS

- » Max ambient temperature up to 40°C
- » Max fluid temperature up to 80°C
- » Max pressure up to 10 bar
- » Installed in a covered area, protected against the weather.



2DP550A

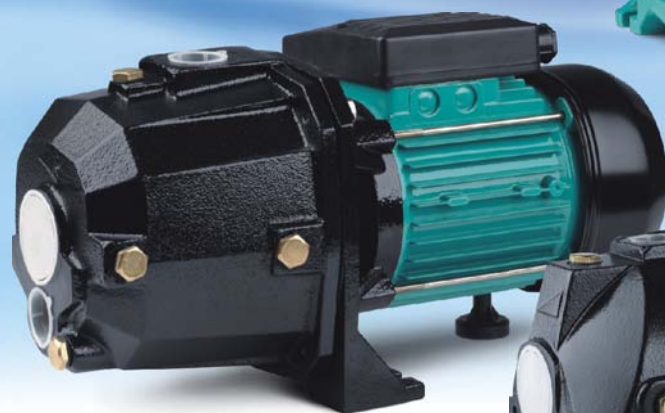

JETDP



JDW



2DP550B

### APPLICATIONS AND INSTALLATION

The DP pumps are regarded as one of best pumps for deep well. In fact they consist of two pumps connected in series, ejector-pump and the other is centrifugal pump. The ejector pump is lowered in well and connected to centrifugal pump body by two pipes. These pumps are suitable for pumping clean water and chemically non-aggressive fluids. They are extremely reliable, economical and simple to use, finding many use in domestic applications and the automatic distribution of water from small and medium-sized surge tanks form an automatic booster systems to supply water. The most remarkable character is that they can be used to supply clean water from extremely deep well. To ensure adequate counter-pressure, it is always to install a foot valve with a filter on the suction opening.

### CONSTRUCTION FEATURES

- » Pump body: Cast iron
- » Motor housing: Aluminum
- » Shaft: 45#Steel / Stainless steel
- » Impeller: Brass / PPO
- » Motor: Closed, Externally ventilated
- » Insulation class: F
- » Protection class: IP44 / IP54
- » Duty: Continuously rated
- » Mechanical seal: Ceramic steatite / Metalized carbon

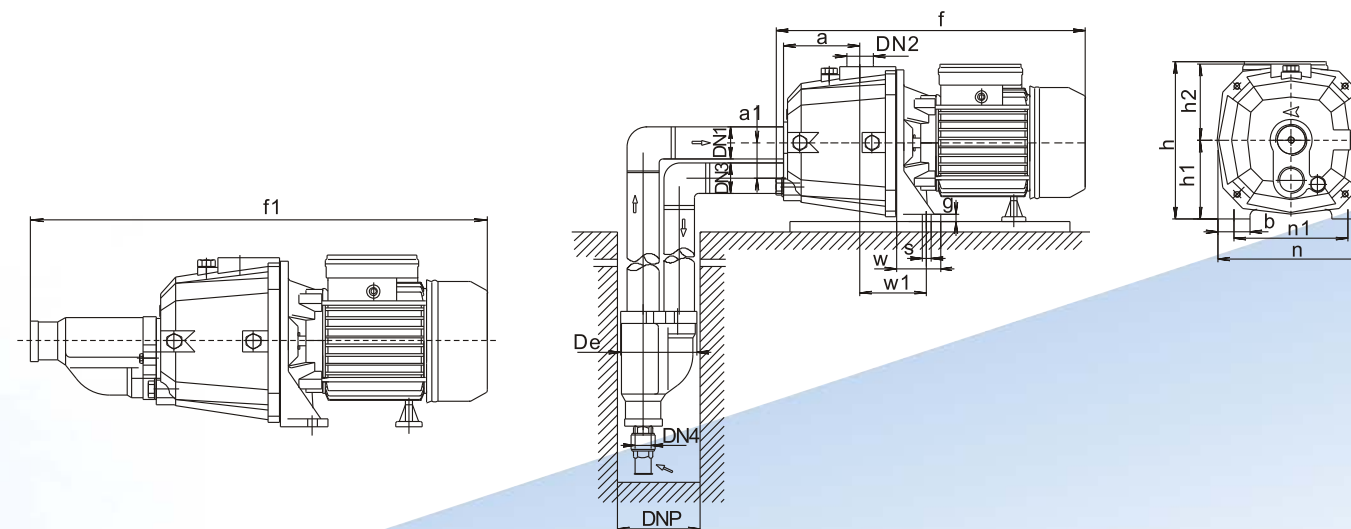

### DIMENSIONS

Model	Dimensions (mm)																	Weight (kg)		Packing Size (mm)			Packing QTY.		
	DNP	DN1	DN2	DN3	De	a	a1	f	f1	h	h1	h2	n	n1	w	w1	b	g	s	NW	GW	L		W	H
JETDP255A	4"	1.25"	1"	1"	96	95	43	387	520	196	98	95	182	142	55	84	40	9	11	14.8	15.8	400	300	230	850
JETDP370A	4"	1.25"	1"	1"	96	95	43	387	520	196	98	95	182	142	55	84	40	9	11	14.5	15.5	400	300	230	850
JETDP550A	4"	1.25"	1"	1"	96	95	43	387	520	196	98	95	182	142	55	84	40	9	11	15.5	16.5	400	300	230	850
2DP550A	4"	1.25"	1"	1"	96	95	43	387	520	196	98	95	182	142	55	84	40	9	11	25.0	17.5	550	450	260	850
2DP750A	4"	1.25"	1"	1"	96	51	43	395	-	258	110	147	198	145	-	117	65	12	12	27.0	26	550	450	220	700

### TECHNICAL DATA

Model	Input Power		Current (A)	Size DN1XDN2XDN3	Capacitor (mF)	Total Head (m)	Injector Type	Sect. H	Capacity L/min At discharge head m					
	kW	HP							10m	15m	25m	35m	40m	
JETDP255A	0.37	0.5	2.1	1.25"X1"X1"	12	40	E20	10	34	12	8			
								15	20	5	5			
								20	13	7	4			
JETDP370A	0.55	0.75	2.4	1.25"X1"X1"	16	50	E20	10	42	18	15			
								15	25	16	10			
								20	20	10	7			
JETDP550A	0.75	1	3.5	1.25"X1"X1"	16	55	E20	15	38	24	28			
								20	30	17	15			
								30	21	12	10			
2DP550A	1	1.5	4.6	1.25"X1"X1"	20	55	E20	15	50	43				
								20	40	30				
								30	31	25				
2DP750A	1.5	2	6.2	1.25"X1"X1"	30	70	E20	10	58	50	40			
								15	50	56	47	35		
								25	34	46	35	20		
							E30	35	17	38	30	16	4	

Standard data and equipment: single phase 220V/50Hz, NORYL impeller, carbon steel motor shaft, with terminal protector inside. Others model and material such as three phase, 110V, 60Hz, dual voltage, stainless steel shaft, Brass impeller, etc, will be available upon request.

### MODEL MEANING

TDL 1, 2, 3, 4, 8, 12, 16, 20

TDL 8 - 2

Stage Number

Rated Flow

light stainless steel multistage pumps



Constence Pressure System

SECTIONAL DRAWING (TDL 1, 2, 3, 4)

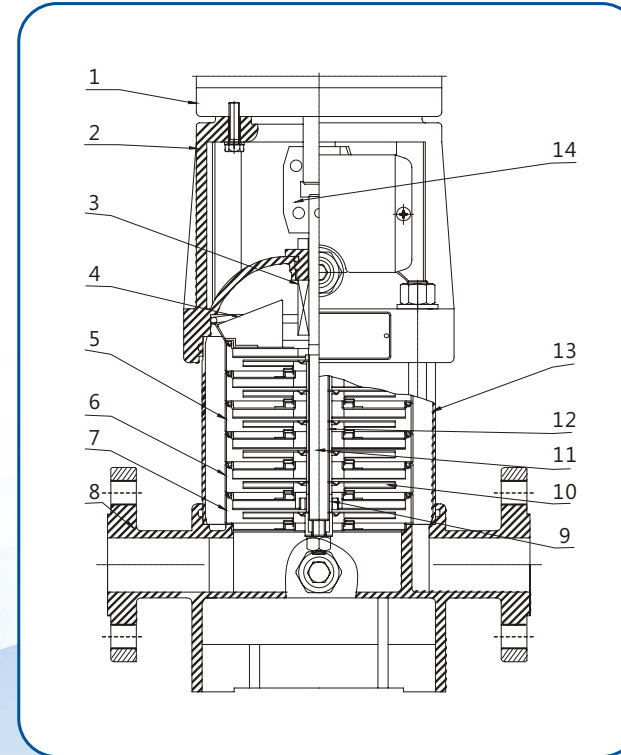

SECTIONAL DRAWING (TDL 8, 12, 16, 20)

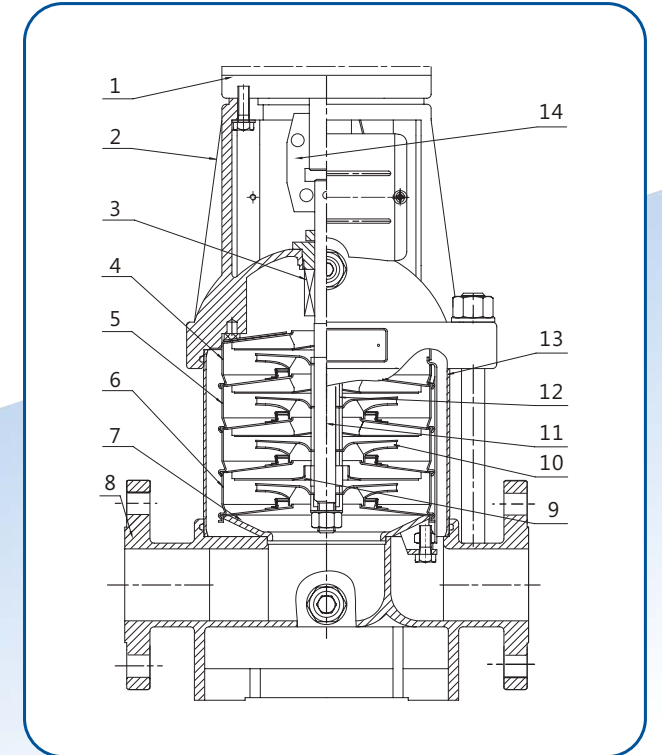

DATA(TDL 1,2, 3,4, 8, 12, 16, 20)

NO.	NAME	DATA	AISI/ASTM
1	Electric Motor		
2	Pump Head	Cast Iron	ASTM25B
3	Mechanical Seal		
4	Guide Outlet	Stainless Steel	AISI304
5	Guide Vane	Stainless Steel	AISI304
6	Guide Holder	Stainless Steel	AISI304
7	Guide	Stainless Steel	AISI304
8	Outlet	Tung Carbide	ASTM25B
9	Bearing	Cast Iron	
10	Impellor	Stainless Steel	AISI304
11	Shaft	Stainless Steel	AISI304 AISI316L
12	Impellor Cover	Stainless Steel	AISI304
13	Pump Body	Stainless Steel	AISI304
14	Shaft Connector	Carbon Steel	

Model	Max. Head (m)	Max. Flow (m <sup>3</sup> /h)	Power (kW)	Speed (r/min)
TDL 1-2	11.5	1	0.37	2900
TDL 1-3	17	1	0.37	2900
TDL 1-4	22.5	1	0.37	2900
TDL 1-5	28	1	0.37	2900
TDL 1-6	36	1	0.37	2900
TDL 1-7	39	1	0.37	2900
TDL 1-8	45	1	0.55	2900
TDL 1-9	51	1	0.55	2900
TDL 1-10	57	1	0.55	2900
TDL 1-17	95	1	1.1	2900
TDL 1-19	106	1	1.1	2900
TDL 1-21	117	1	1.1	2900
TDL 1-23	128	1	1.1	2900
TDL 1-25	139	1	1.5	2900
TDL 1-27	150	1	1.5	2900
TDL 1-30	166	1	1.5	2900
TDL 1-33	183	1	2.2	2900
TDL 1-36	200	1	2.2	2900
TDL 2-2	15	2	0.37	2900
TDL 2-3	22	2	0.37	2900
TDL 2-4	30	2	0.55	2900
TDL 2-5	37	2	0.55	2900
TDL 2-6	45	2	0.75	2900
TDL 2-7	52	2	0.75	2900
TDL 2-9	67	2	1.1	2900
TDL 3-27	124	3	2.2	2900
TDL 3-29	133	3	2.2	2900
TDL 3-31	142	3	3	2900
TDL 3-33	151	3	3	2900
TDL 3-36	168	3	3	2900
TDL 4-2	15	4	0.37	2900
TDL 4-3	24	4	0.55	2900
TDL 4-4	32	4	0.75	2900
TDL 4-5	40	4	1.1	2900
TDL 4-6	48	4	1.1	2900
TDL 4-7	56	4	1.5	2900
TDL 4-8	64	4	1.5	2900
TDL 4-10	81	4	2.2	2900
TDL 4-12	95	4	2.2	2900
TDL 4-14	112	4	3	2900
TDL 4-16	129	4	3	2900
TDL 4-19	153	4	4	2900
TDL 4-22	178	4	4	2900
TDL 8-2/1	9	8	0.75	2900
TDL 8-2	18	8	0.75	2900
TDL 8-3	27	8	1.1	2900

Model	Max. Head (m)	Max. Flow (m <sup>3</sup> /h)	Power (kW)	Speed (r/min)
TDL 8-4	36	8	1.5	2900
TDL 8-5	45	8	2.2	2900
TDL 8-6	54	8	2.2	2900
TDL 8-8	73	8	3.0	2900
TDL 8-10	92	8	4.0	2900
TDL 8-12	111	8	4.0	2900
TDL 8-14	130	8	5.5	2900
TDL 8-16	148	8	5.5	2900
TDL 8-18	167	8	7.5	2900
TDL 8-20	186	8	7.5	2900
TDL 12-2	20	12	1.5	2900
TDL 12-3	30	12	2.2	2900
TDL 12-4	40	12	3	2900
TDL 12-5	50	12	3	2900
TDL 12-6	60	12	4	2900
TDL 12-7	70	12	5.5	2900
TDL 12-8	80	12	5.5	2900
TDL 12-9	91	12	5.5	2900
TDL 12-10	101	12	7.5	2900
TDL 12-12	121	12	7.5	2900
TDL 12-14	141	12	11	2900
TDL 12-16	162	12	11	2900
TDL 12-18	183	12	11	2900
TDL 16-2	22	16	2.2	2900
TDL 16-3	34	16	3.0	2900
TDL 16-4	46	16	4.0	2900
TDL 16-5	58	16	5.5	2900
TDL 16-6	70	16	5.5	2900
TDL 16-7	82	16	7.5	2900
TDL 16-8	94	16	7.5	2900
TDL 16-10	118	16	11	2900
TDL 16-12	141	16	11	2900
TDL 16-14	166	16	15	2900
TDL 16-16	189	16	15	2900
TDL 20-1	10	20	1.1	2900
TDL 20-2	23	20	2.2	2900
TDL 20-3	35	20	4.0	2900
TDL 20-4	47	20	5.5	2900
TDL 20-5	58	20	5.5	2900
TDL 20-6	70	20	7.5	2900
TDL 20-7	82	20	7.5	2900
TDL 20-8	94	20	11	2900
TDL 20-10	118	20	11	2900
TDL 20-12	142	20	15	2900
TDL 20-14	166	20	15	2900
TDL 20-17	202	20	18.5	2900

# CP (C)

## CIRCULATION PUMP



CP15/4C

CP32/4C

CP25/4C

### PUMP

- » Liquid temp: -10°C to +110°C
- » Operat. pres: Max. 10bar
- » Ambient temp: 40°C
- » Fitting length: 130mm 180mm

### APPLICATIONS

- » Heating systems
- » Domestic hot water systems
- » Cooling and air-conditioning systems
- » Water circulating system for industrial micro boiler

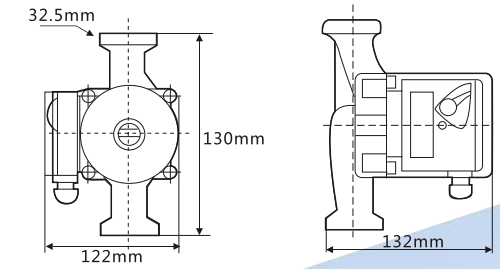
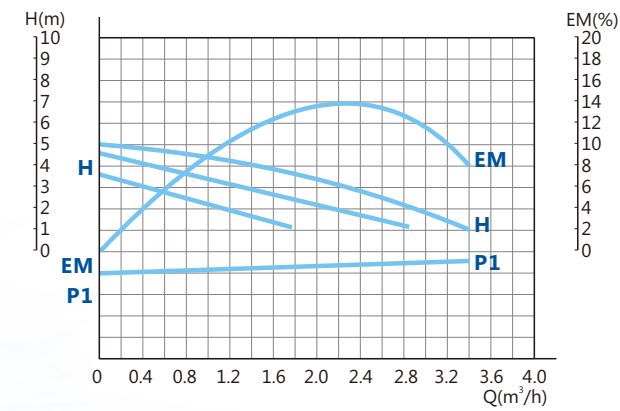

Model	Power W	Max. Flow L/min	Max. Head M	Inlet/Outlet In	NW Kg
CP15/4C	72/53/38	42/34/23	4.5/4/3	1"X1"	2.2

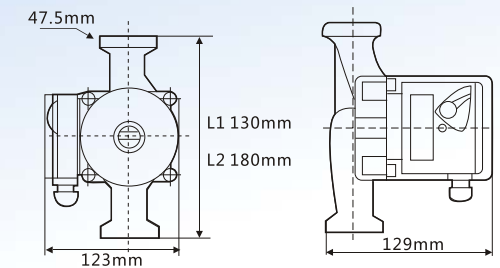
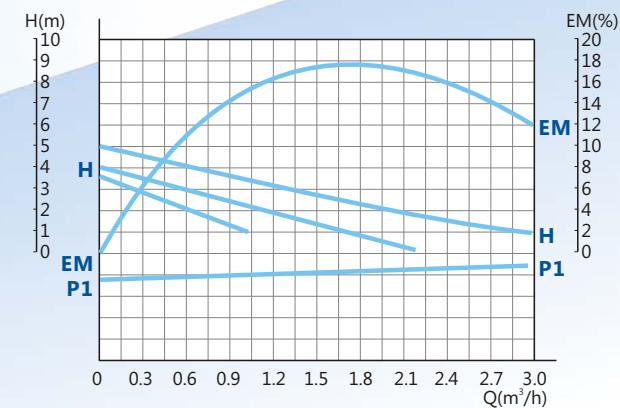

Model	Power W	Max. Flow L/min	Max. Head M	Inlet/Outlet In	NW Kg
CP25/4C	72/53/38	48/36/18	4.5/4/3	1 1/2"X1 1/2"	2.4

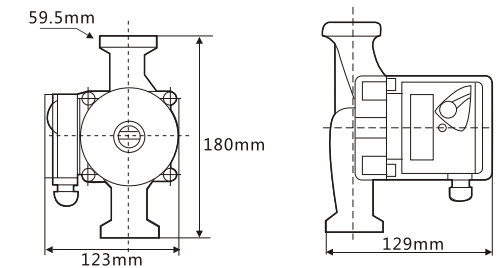
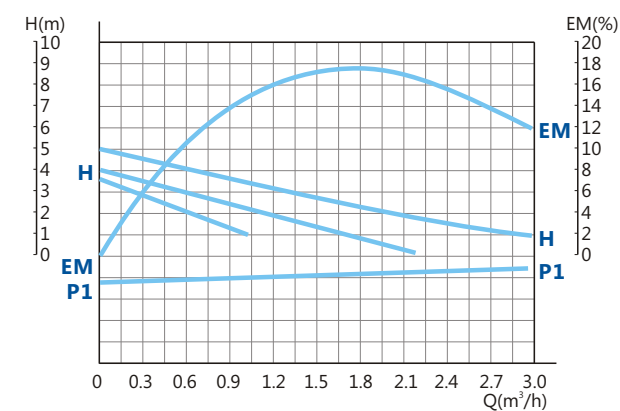

Model	Power W	Max. Flow L/min	Max. Head M	Inlet/Outlet In	NW Kg
CP32/4C	72/53/38	48/36/18	4.5/4/3	2"X2"	2.4

# CP (C)

## CIRCULATION PUMP

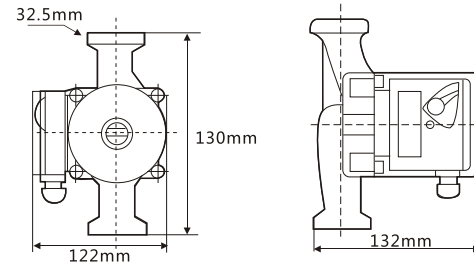
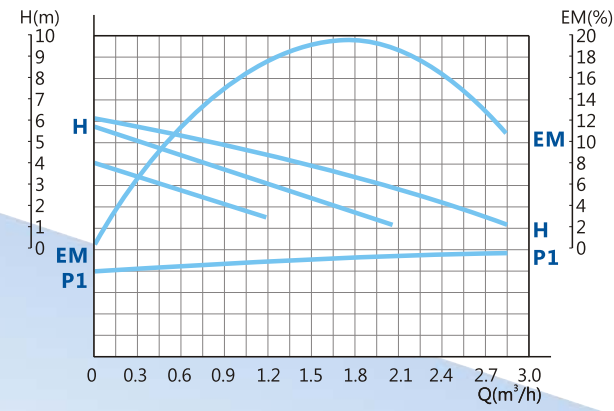

Model	Power W	Max. Flow L/min	Max. Head M	Inlet/Outlet In	NW Kg
CP15/6C	93/67/46	48/35/21	6/5/3	1"X1"	2.2

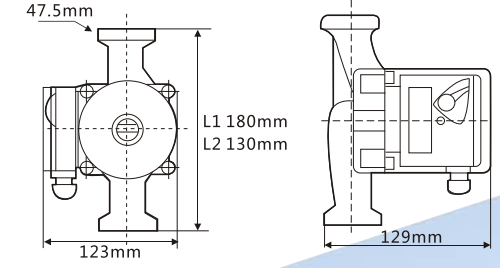
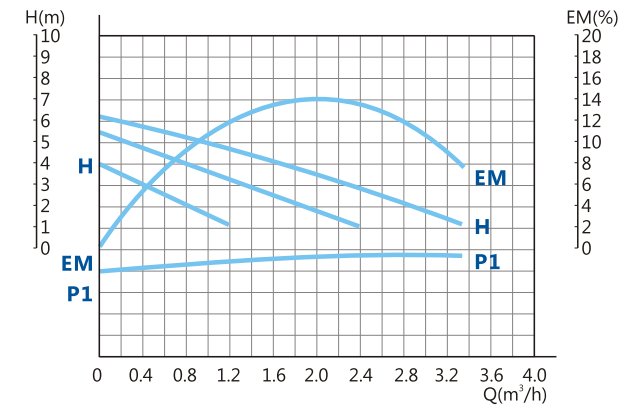

Model	Power W	Max. Flow L/min	Max. Head M	Inlet/Outlet In	NW Kg
CP25/6C	93/67/46	55/38/22	6/5/3	1 1/2"X1 1/2"	2.4

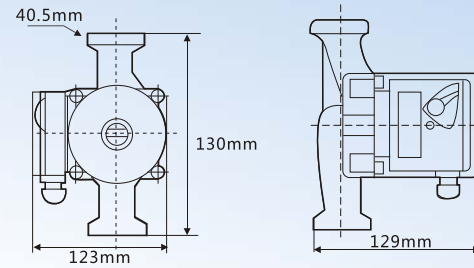
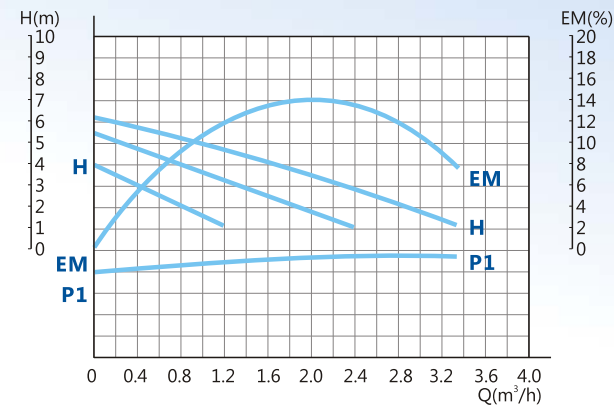

Model	Power W	Max. Flow L/min	Max. Head M	Inlet/Outlet In	NW Kg
CP20/6C	93/67/46	55/38/22	6/5/3	1 1/4"X1 1/4"	2.3

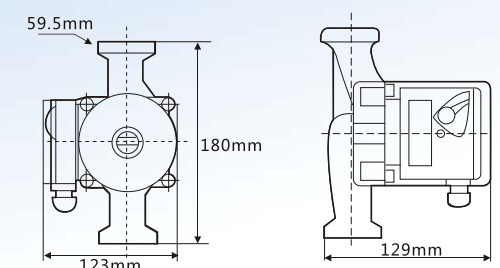
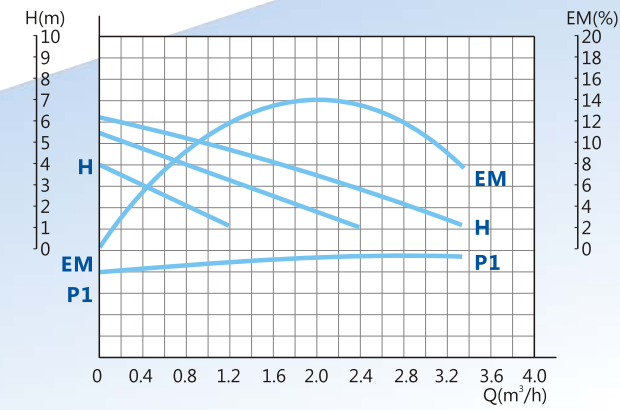

Model	Power W	Max. Flow L/min	Max. Head M	Inlet/Outlet In	NW Kg
CP32/6C	93/67/46	55/38/22	6/5/3	2"X2"	2.5

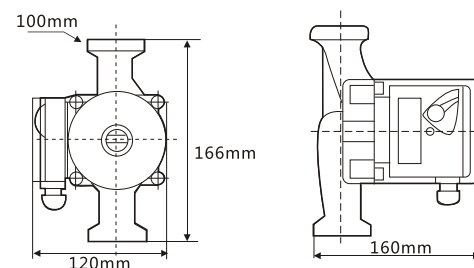
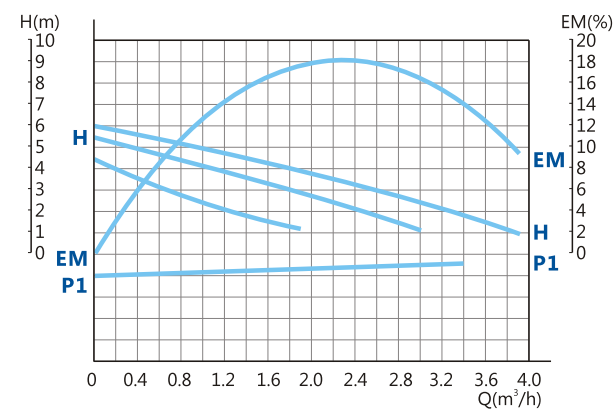

Model	Power W	Max. Flow L/min	Max. Head M	Inlet/Outlet In	NW Kg
CP25/6CF	93/67/46	55/38/22	6/5/3	1 1/2"X1 1/2"	2.6

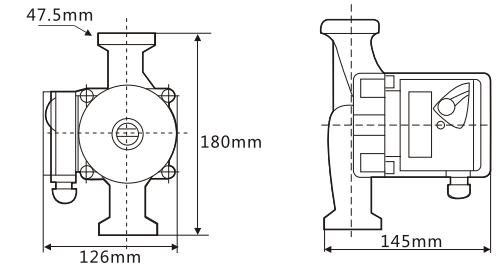
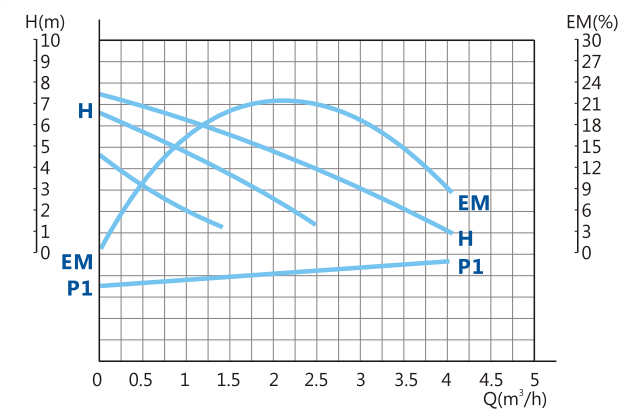

Model	Power W	Max. Flow L/min	Max. Head M	Inlet/Outlet In	NW Kg
CP25/7C	135/93/67	65/44/22	7/6.5/4.5	1 1/2"X1 1/2"	2.8

# AUTO BOOSTER SYSTEM

Automatic high pressure groups coupled with self-priming jet pumps. They are very silent and reliable and particularly suitable to increase pressure from a water system, To supply water from wells and in domestic high pressure groups.

## OPERATING LIMITS

- » Liquid Temperature Up To 60°C
- » Maximum Ambient Temperature 40°C



## ACCESSORY



TANK 24L



PRESSURE GAUGE  
7 Bar(100 Psi)



FLEXIBLE HOSE  
60mm/45mm/33mm



PRESSURE SWITCH  
PC2/PC-2A/PC-9/PC-9A  
Adjusted switch on/off  
pressure 1.4/2.8 bar



CONNECTOR  
Brass 5 Way

# TOP Series OIL PUMP

## OPERATING LIMITS

TOP is an high efficiency diesel pump with small size, big flow, high delivery head. It can work with diesel, machine oil and transformer oil (forbidden to work with easy explosive oil like gasoline etc.), suitable for small gas station and selffilling for mobile machinery shop, trucker and etc.



## TECHNICAL DATA (220~240V/50HZ, 2850rpm)

Model	Flow (L/min)	Height (m)	Power (W)	AMP	VOT.	Fitting
TOP-60D	25	28	400	2.8	230	1"X1"
TOP1-60	39	10	120	2.4	230	1"X1"
TOP2-60	42	17	370	2.5	230	1"X1"

# ACCESSORIES



NOZZLE & VENTURI TUBE

ROTOR

STATOR



Eu-1

Eu-2

SW-1

IT-1

BR-1

IS-2



Stainless steel

Brass

3-way

4-way

5-way

FOOT VALVE

BRASS CONNECTOR

JET NOZZLE

NOZZLE

CONNECTOR



AR-1

KO-2

SA-1

AU-1

AM-1

AM-2



A

B

Impeller-1(Brass)

Impeller-2(Brass)

Impeller-3(PPO)

Impeller-4 (Stainless steel)

BEARING

MECHANICAL SEAL

IMPELLER



MC/6

MR/6

Pressure switch-1

Pressure switch-2

Pressure switch-3

Pressure switch-4

PRESSURE GAUGE

PRESSURE SWITCH



Pressure switch-5

High pressure switch-1

High pressure switch-2

Float control switch

PRESSURE SWITCH



TANK



Steel

Stainless steel

19L  
24L  
36L  
50L  
60L  
80L  
100L

19L  
24L  
36L  
50L  
60L  
80L  
100L

VERTICAL PRESSURE TANK WITH GASBAG (8L,12L, 19L)

HORIZONTAL PRESSURE TANK WITH GASBAG